



POLARIS SPORTSMAN

2023

ACCESSORIES,
GARAGE & APPAREL

US VERSION

FORGE YOUR
OWN PATH



The ATV that defined the industry, Sportsman combines legendary smoothness, unstoppable versatility and an ease of use that the competition continues to chase, which is why Sportsman is chosen by more ATV owners. Whether you're tearing up the trails, working out in the fields, or navigating the wilderness for the perfect hunt, there is a Sportsman story to be told.

LINEUP

SEE THE FULL LINEUP AT [POLARIS.COM/SPORTSMAN](https://polaris.com/sportsman)

450 / 570

P. 12

RECREATION & UTILITY



SPORTSMAN 450 H.O.
(EPS, UTILITY)



SPORTSMAN 570
(EPS, PREMIUM, TRAIL)

TOURING

WORK



SPORTSMAN TOURING 570
(EPS, PREMIUM)



SPORTSMAN
570 6x6

850 / XP 1000 / XP 1000 S

P. 22

RECREATION & UTILITY



SPORTSMAN 850
(PREMIUM, ULTIMATE TRAIL)



SPORTSMAN XP 1000
ULTIMATE TRAIL

TOURING



SPORTSMAN
TOURING 850



SPORTSMAN TOURING
XP 1000 TRAIL

SCRAMBLER 850 / XP 1000 S

P. 30

SPORT PERFORMANCE



SCRAMBLER 850



SCRAMBLER XP 1000 S



SPORTSMAN XP 1000 S

YOUTH

P. 32



OUTLAW 70 EFI

CONTENTS

CONNECTED TECHNOLOGY	6
WINCHES	10
450 / 570	12
WINCHES, PROTECTION & RACKS	14
COMFORT, AUDIO & STORAGE	16
WINDSHIELDS	18
570 6X6, 570 TOURING & 570 X2	20
850 / XP 1000 / XP 1000 S	22
WINCHES, RACKS & PROTECTION	24
STORAGE, AUDIO & COMFORT	26
WINDSHIELDS	28
SCRAMBLER 850 / XP 1000 S	30
YOUTH	32
COMMON ACCESSORIES	34
GLACIER PLOW SYSTEMS	34
TRACKS	36
WHEELS & TIRES	38
LIGHTING	44
HUNT	46
POLARIS NORTHSTAR COOLERS	48
PARTS & GARAGE	50
MAINTENANCE	50
OIL & LUBRICANTS	52
MAINTENANCE FLUIDS	54
GARAGE ACCESSORIES & BATTERY CHARGERS	56
HO PARTS	58
SERVICE PARTS	60
TIRE SEALANT & TRAILERING	62
POLARIS POWER	64
APPAREL	70
JERSEYS & GLOVES & HEATED APPAREL	72
HELMETS & GOGGLES	74
MEN'S APPAREL	76
BALL CAPS	80
CAMO APPAREL	81
WOMEN'S APPAREL	82
HOME & COLLECTIBLES	84

SHOP ALL SPORTSMAN ACCESSORIES AT
[POLARIS.COM/ShopSPORTSMAN](https://polaris.com/ShopSPORTSMAN)

KEEP YOUR STANDARDS HIGH. WE DO.

DESIGNED

by the people who
designed your vehicle.



TESTED

extensively in the field so you
ride with 100% confidence.



TRUSTED

65 years in the business.
The #1 name in Off-Road.

ACCESSORIES
BACKED BY A



WARRANTY



**WE HOLD OUR
PARTNERS
TO THE SAME
STANDARDS**



WHEELS, TIRES & LIGHTING DESIGNED
WITH POLARIS TO MAXIMIZE PERFORMANCE
P. 38, 45



A GLOBAL LEADER IN AUDIO INNOVATION,
DESIGN & ENGINEERING
P. 17, 27



PRODUCTS SO GOOD THEY REPLACE
OR REPAIR THEM FOR LIFE
P. 44



MAKING PRODUCTS FOR
AVID SPORTSMEN SINCE 1943
P. 46



DIGITAL GAUGES FOR
POWERSPORTS RIDERS
P. 7

ENGINEERED FOR MORE

Ensuring Polaris Engineered Accessories fit and work in sync with your machine is the most critical phase of testing and validation. With seamless integration, you can trust that any Polaris accessory you install will enhance your interaction beyond your expectations.

POLARIS
ENGINEERED

LOCK & RIDE®

CARGO VERSATILITY

Lock & Ride mounting locations allow for limitless customization to let you work the way you want.

P.17, 26

POLARIS RIDECOMMAND

PLAN. TRACK. SHARE. CONNECT.

Ride in confidence with industry-exclusive technology showing the way on the Polaris app powered by RIDE COMMAND.

P.6

PRO PRO HEAVY DUTY SERIES

WINCHES

INTEGRATED WINCH MOUNT & PRE-WIRED

Designated mounting points and pre-wired contactors ensure a perfect fit and the strongest place to attach the Polaris Engineered winch - the most dependable winch for your Sportsman. With wiring built right into the vehicle, we made this the easiest Sportsman winch ever made to install.

P.10

GLACIER® PLOW SYSTEM

INTEGRATED PLOW MOUNT

The attachment points for the Glacier Plow System are integrated right at the factory and feature an innovative drive-up and go installation process.

P.34



CONNECTED TECHNOLOGY

ENHANCE YOUR RIDE.



POLARIS RIDECOMMAND

PLAN YOUR RIDE

Plan an epic ride with stops along the way, customize and adjust your path to maximize your route or follow turn-by-turn directions. You can even share your planned route with friends.

FOLLOW THE GROUP

With Group Ride, you can ride at your own speed and keep fellow riders in sight on your map screen, even if you get split up. Because rides are meant to be shared.

WORK SMARTER

Plow Mode automatically raises and lowers the plow depending on the gear you're in, so that you can get your work done quicker.

DISCOVER NEW TRAILS

With over 1,000,000 miles of trails available offline, you'll have the confidence to explore further, whether you have cellular coverage or not.

AVAILABLE ON RIDE COMMAND EDITION MODELS & AS AN ACCESSORY
7" DISPLAY POWERED BY RIDE COMMAND*

- **Bright, 7" touchscreen** visible in all conditions.
 - **Configurable Gauges**
Customize your ride experience with elevation, travel direction, fuel level and more to create relevant screens for you.
- **Personalized Audio Experience**
Seamlessly pair your display via Bluetooth® to wirelessly stream music and stay connected with call and text alerts. Add the Lock & Ride Rear Audio Storage Box to stream music. (Requires Lock & Ride Rear Audio Storage Box and Rear Power Harness.)
- **Industry's Only Plow Mode**
Quick and easy plowing. Plow automatically lowers when shifted into low gear and raises when shifted into reverse. (Requires Polaris Winch with Auto Stop Technology and Synthetic Rope. Learn more on P. 10.)
- **7" Display Mount Kit Included**
Comes with required wiring harnesses and accessory components. Includes V2V and GPS antenna.

» 2889455 • \$1,499⁹⁹
SPORTSMAN 450/570 '22-'23, SPORTSMAN 850/1000 '22-'23

LEARN MORE AND DOWNLOAD AT
RIDECOMMAND.POLARIS.COM



*Due to ongoing supply chain issues, there may be delayed or limited availability of this product as an accessory add-on.

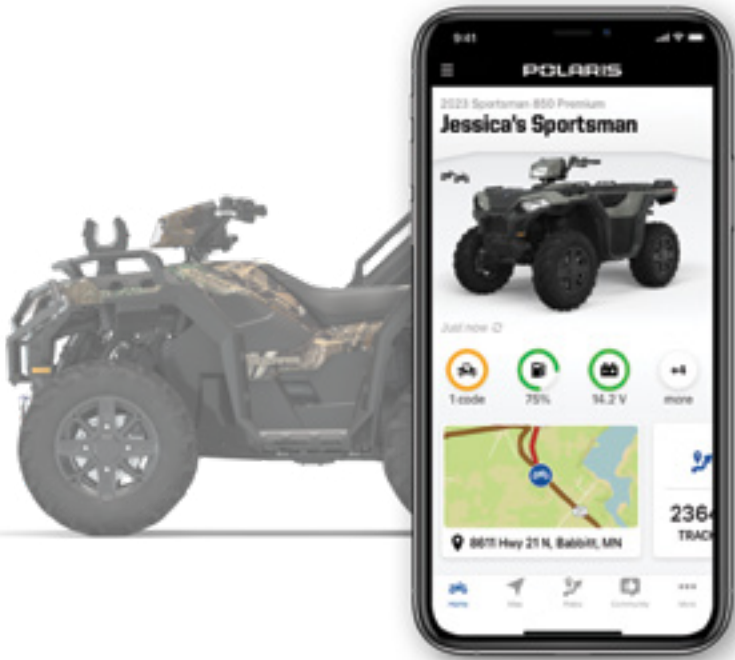

	POLARIS RIDECOMMAND	POLARIS RIDECOMMAND+
VEHICLE OWNERSHIP	GARAGE	✓
	WARRANTY STATUS	✓
	MAINTENANCE TRACKING	✓
	ISSUE DIAGNOSTIC	✓
	VEHICLE HEALTH	✓
RIDING FEATURES	COMMUNITY	✓
	CONTENT SHARING	✓
	RIDE PLANNING	✓
	WAYPOINTS	✓
	RIDE TRACKING	✓
	RIDE TRACKING+	✓
	GROUP RIDE	✓
SECURITY	GROUP RIDE+	✓
	VEHICLE LOCATOR	✓
	LOCATION ALERTS	✓
	BUMP ALERT	✓

POLARIS INTRODUCING RIDECOMMAND+

THE LATEST IN INDUSTRY-LEADING CELLULAR TECHNOLOGY CONNECTING YOU TO YOUR VEHICLE

Vehicle location and health in the palm of your hand.
Over the air updates with new feature releases.

NEW
AVAILABLE ON SELECT 2023 MODELS
PLUG-IN**

- **Vehicle Locator**
Pinpoint exactly where your vehicle is at any time, on or off your property. Using the Polaris App powered by RIDE COMMAND, the vehicle locator gives you the peace of mind that you will be able to get back your ride.
- **Vehicle Health**
Before you head out, log in using the Polaris App to remotely check on the readiness of your ride for the day you have planned. Monitor gas or battery condition, estimated range and oil change status for a confident start to the day.
- **Bump Alert Coming Soon!**
Protect your investment by keeping tabs on it 24/7. Receive a notification if your vehicle has been bumped or moved from its last location and track.
- **Ride Tracking+ Coming Soon!**
Map the details of your entire ride automatically including route, average speed, time elapsed, elevation changes and more. You can even save tracked rides and go back to your favorite spots or share with your friends.
- » PLUG-IN • 2890038 • \$299⁹⁹
SPORTSMAN 450/570 '23,
SPORTSMAN 850/1000 '23,
SPORTSMAN XP1000 '23
- » INSTALL KIT • 2889534 • \$39⁹⁹
SPORTSMAN 570 RIDE COMMAND EDITION '23,
SPORTSMAN 570 UTILITY HD '23, SPORTSMAN 570
EPS '23, SPORTSMAN 570 PREMIUM EPS '23,
SPORTSMAN 570 TRAIL '23
REQUIRED IN ADDITION TO 2890038
- » INSTALL KIT • 2889535 • \$39⁹⁹
SPORTSMAN XP1000 '23, SPORTSMAN 850 '23
REQUIRED IN ADDITION TO 2890038
- » INSTALL KIT • 2889615 • \$69⁹⁹
SPORTSMAN 450/570 '23
REQUIRED IN ADDITION TO 2890038

**Check with your local dealer for availability.



LEARN MORE AT
TRAILTECH.NET

VOYAGER PRO KIT, ATV

- Bright, 4" touchscreen visible in all conditions.
- Compatible with RIDE COMMAND.
- **Pre-Loaded Base Maps**
The map screen is enabled with base maps, topography lines, hill shading and select trails. Record or load GPS trails/riding areas and transfer to a PC.
- **Buddy Tracking**
Track up to 20 group members no matter what type of vehicle they are riding.
- **Bluetooth® Enabled**
Bluetooth® enabled for intercom, phone and media controls. Play songs from your phone or MicroSD card using a Bluetooth® headset, speaker or intercom. Two phones and two headsets can be connected at the same time.

» MODEL-SPECIFIC KITS • \$649⁹⁵

AVAILABLE AT YOUR LOCAL DEALER OR ONLINE AT TRAILTECH.NET

SUPERIOR INTEGRATION

POLARIS ENGINEERED WINCHES

- ✓ Tested 1,200+ pulls at max load, it works when you need it to
- ✓ Built for winter, withstands -20° F temperatures
- ✓ **Pre-wired chassis**
Factory-installed wiring makes the controls simple to install. Mount the winch, connect the wires and trust that everything is routed safely, securely, and properly.
- ✓ **No need to cut panels**
- ✓ Sealed motor and heavy-duty gears operate fully submerged underwater
- ✓ Military tested and approved

LEARN MORE ABOUT
POLARIS ENGINEERED WINCHES
SEE P. 10

Right from the factory, your vehicle is built to make essential accessories like winches and plows easy to use day-in and day-out. Mounting brackets are designed into the oversized factory bumper and wiring is routed securely and properly. When it comes to Sportsman, Polaris Engineered Accessories make work easier so you can get more done.

POLARIS
ENGINEERED

GLACIER[®] PLOW SYSTEM

- ✓ Easily engage and disengage the plow system from your Sportsman
- ✓ No loss of factory ground clearance when not plowing
- ✓ Don't have to crawl under the machine to release the plow blade from the vehicle
- ✓ No trimming of vehicle plastic required to mount plow or winch

LEARN MORE ABOUT THE
GLACIER PLOW SYSTEM
SEE P. 34

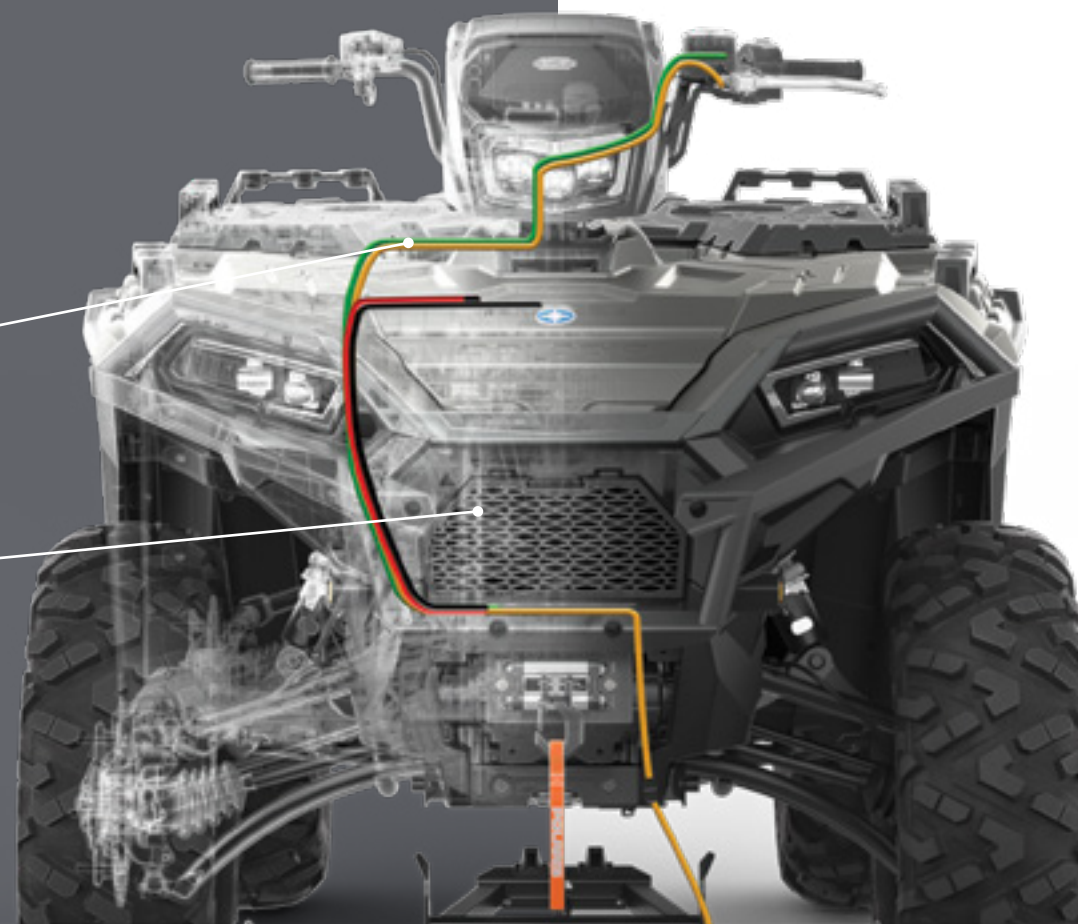

WINCHES



ADD A PLOW
P. 34

DEPENDABLE. TOUGH.
BUILT FOR THE OFF-ROAD.

A Polaris Engineered winch is designed to help you get the job done right, get you on your way faster and prepare you for the unexpected.

WHY POLARIS?

Polaris off-road vehicles are engineered with designated mounting points and wiring for seamless install of Polaris Engineered winches.



TESTED **1,200+**
PULLS AT MAX LOAD



BUILT TO WITHSTAND
-20° F TEMPERATURES



OPERATES FULLY
SUBMERGED



MILITARY
TESTED & APPROVED

REPLACEMENT PART



REPLACEMENT
STEEL CABLE

- 2,500 winch series - 50 ft.
- » 2878890 • \$44⁹⁹



RECOVERY STRAP

- 2" x 30' (18,000 lb.)
- Comes with carry bag
- » 2884033 • \$59⁹⁹

FEATURES & BENEFITS

ALL POLARIS ENGINEERED WINCHES COME WITH:



WARRANTY

- ✓ INTEGRATED WIRING, MOUNT, PREASSEMBLED
- ✓ HOOK WITH STRAP
- ✓ CUT STEEL GEARS & SEALED DRIVETRAIN
- ✓ SEALED PERMANENT MAGNET MOTOR

RAPID ROPE RECOVERY



Retrieve cable 5x as fast as standard mode on other Polaris winches. Get back to riding or complete your task quicker.

1. Set winch dial to N (Neutral) to manually pull the rope out and secure the hook to your anchor point
2. Set winch dial to L (Low) for maximum pulling power while winching your load
3. Set winch dial to H (High) for retrieving the rope 5x faster with Rapid Rope Recovery

AUTO STOP TECHNOLOGY

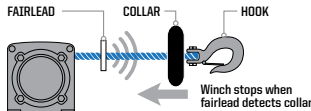

Auto Stop technology protects and extends the life of your winch by automatically stopping the winch at the end of pull to prevent over-spooling. While plowing, it prevents the plow frame from bending by stopping the winch once the plow has been lifted.

PREMIUM SYNTHETIC ROPE

With its lightweight, yet extremely strong, design and superior flexibility, this 50 ft. long synthetic rope is easy to handle and can stand up to any tough job.

WIRELESS REMOTE



This convenient remote operates your Polaris winch wirelessly from within 50 ft. of the vehicle. Operate your winch safely outside your vehicle while on the job site or trails.

MODEL

450 H.O. '21-23
570 '21-23

450 H.O. '16-20
570 '14-20
X2 570 '15-21
TOURING 570 '14-21
6X6 570 '17-21

850 '12-23
XP 1000 '15-23
TOURING XP 1000 '15-23
TOURING 850 '15-23
SCRAMBLER 850 '14-23

SPORTSMAN XP 1000 S '20-23
SCRAMBLER XP 1000 S '20-23

PRO PRO HEAVY DUTY SERIES

TOP-OF-THE-LINE FEATURES

BEST FOR PLOWING, HEAVY-DUTY OUTDOOR CHORES & TRAIL RIDING



PRO PRO HEAVY DUTY SERIES



HD HEAVY DUTY SERIES

BUILT FOR THE OFF-ROAD

BEST FOR THE CASUAL OFF-ROAD RIDER



HD HEAVY DUTY SERIES



NOT AVAILABLE

ADD AUTO STOP TECHNOLOGY



2881693 • \$109⁹⁹
SYNTHETIC ROPE REQUIRED
FITS WINCHES: 2880434, 2880432



2889253 • \$109⁹⁹
SYNTHETIC ROPE REQUIRED
FITS WINCHES: 2884832, 2884833, 2889469, 2889470



TOP SELLER
ADD SYNTHETIC ROPE
2878888 • \$84⁹⁹

ADD WIRELESS WINCH REMOTE



2879316 • \$139⁹⁹

3,500 LB.
with Synthetic Rope

TOP SELLER
2884834
\$564⁹⁹

2889471
\$564⁹⁹

2883580
\$564⁹⁹

3,500 LB.
with Synthetic Rope

TOP SELLER
2884833
\$484⁹⁹

TOP SELLER
2880434
\$484⁹⁹

2889470
\$484⁹⁹

2,500 LB.
with Steel Cable

TOP SELLER
2884832
\$409⁹⁹

TOP SELLER
2880432
\$409⁹⁹

2889469
\$409⁹⁹



COMFORT ESSENTIALS

DOMINATE THE TRAILS with a combination of ultimate comfort and style with our trail-focused accessories. Get the most out of your Sportsman with this collection of accessories to help extend your day out on the trails.

Polaris Pro HD 3,500 lb. Winch	P. 14	LED Light Kit	P. 16	Pro Armor Wheel & Tire Set: Dual Threat/4202	P. 43
Trail Brushguard	P. 14	Rear Power Harness	P. 16	Lug Nuts	P. 43
Rear Brushguard	P. 14	LOCK & RIDE Rear Audio Storage Box	P. 17	RIGID® D-Series Pro Driving LED Light	P. 44
Rear Rack Extender	P. 15	Audio Storage Box Remote	P. 17	Lightbar Harness	P. 45
Handguards	P. 16	Pod Bag	P. 17	LED Y-Harness	P. 45
Handguard Mount	P. 16	Fender Bag	P. 17		

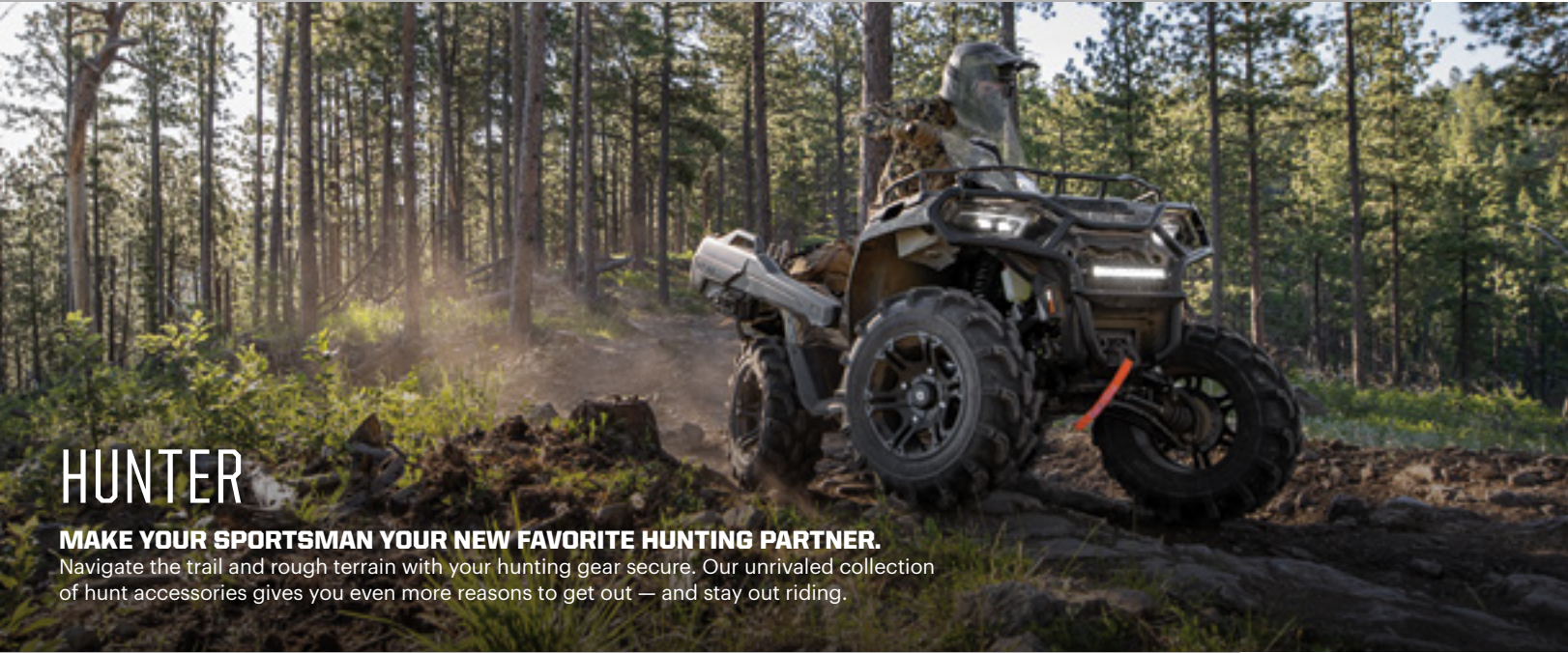

HUNTER

MAKE YOUR SPORTSMAN YOUR NEW FAVORITE HUNTING PARTNER. Navigate the trail and rough terrain with your hunting gear secure. Our unrivaled collection of hunt accessories gives you even more reasons to get out — and stay out riding.

Polaris HD 3,500 lb. Winch	P. 14	LOCK & RIDE Tall Windshield	P. 18	Lightbar Harness	P. 45
HD Front Brushguard with Hitch	P. 14	Pro Armor Wheel & Tire Set: Mud XC/4205	P. 43	Gun Boot L	P. 46
Rear Rack Extender	P. 15	Lug Nuts	P. 43	Stronghold Auto-Latch Mount	P. 46
Hand & Thumb Warmer Kit	P. 16	RIGID® SR-Series 10" Combo LED Light	P. 45	LOCK & RIDE Rhino Grip Pro	P. 47

WORK HARD AND GET IT DONE with Polaris Engineered Accessories. Find everything you need to outfit your trusted partner for the task at hand.



WORKER

CONQUER THE TOUGHEST OUTDOOR TASKS with the capabilities of your Sportsman. Haul your tools, gear, and more with our utility-focused accessories, designed to help you get the job done around your property, farm, or ranch.

Polaris HD 2,500 lb. Winch	P. 14	Rear Rack Extender	P. 15	LOCK & RIDE Open Cargo Box	P. 17
Rear Brushguard	P. 14	Front Utility Rack	P. 15	LOCK & RIDE Mid Windshield	P. 18
HD Front Brushguard with Hitch	P. 14	Rear Utility Rack	P. 15	Pro Armor Wheel & Tire Set: Harvester/4204	P. 43
Body Armor	P. 15	Rear Power Harness	P. 16	Lug Nuts	P. 43



WINTER

GET MORE DONE with your Sportsman no matter what season it is. Conquer the toughest winter chores with our winter accessories to maximize comfort while plowing more snow in colder weather.

Polaris Pro HD 3,500 lb. Winch	P. 14	LOCK & RIDE Rear Cargo Box	P. 17	Glacier Pro Plow Blade - 66" Poly	P. 35
HD Front Brushguard with Hitch	P. 14	LOCK & RIDE Tall Windshield	P. 18	RIGID® SR-Series 10" Combo LED Light	P. 45
Rear Rack Extender	P. 15	Glacier Integrated Plow Mount	P. 35	Lightbar Harness	P. 45
Hand & Thumb Warmer Kit	P. 16	Glacier Pro Steel ATV Plow Frame	P. 35		

SPORTSMAN 450 • 570



WINCHES

POLARIS PRO HD 3,500 LB. WINCH TOP SELLER

- Adds 3,500 lbs of pulling capacity with Auto Stop Technology for plowing applications
- Rapid Rope Recovery recovers open cable 5x as fast as standard mode on other Polaris winches

» 2884834 • \$564⁹⁹

SPORTSMAN 450/570 '21-23



RAPID ROPE RECOVERY



LEARN MORE
P. 10

POLARIS HD 3,500 LB. WINCH TOP SELLER

- Adds 3,500 lbs of pulling capacity with quick and easy installation
- Includes all components required for installation plus 50 ft. of 3/16" premium high-strength synthetic rope

» 2884833 • \$484⁹⁹

SPORTSMAN 450/570 '21-23



POLARIS HD 2,500 LB. WINCH TOP SELLER

- Adds 2,500 lbs of pulling capacity with quick and easy installation
- Includes all components required for installation plus 50 ft. of 3/16" high-strength steel cable

» 2884832 • \$409⁹⁹

SPORTSMAN 450/570 '21-23



NEED A PLOW? SEE P. 34

[POLARIS.COM/ShopSPORTSMAN](https://www.polaris.com/shopSPORTSMAN)

PROTECTION

TRAIL BRUSHGUARD TOP SELLER

- Provides enhanced protection from brush and debris
- Has designated light bar holes and is compatible with winch and Body Armor

» 2884844 • \$204⁹⁹

SPORTSMAN 450/570 '21-23



REAR BRUSHGUARD TOP SELLER

- Protect your vehicle from brush, sticks, rocks and light bumps into solid objects
- Made of sturdy 1.25" steel tube with a matte black finish

» 2884847 • \$194⁹⁹

SPORTSMAN 450/570 '21-23



HD FRONT BRUSHGUARD WITH HITCH

- Adds heavy-duty protection with a custom look
- Has designated light bar holes and is compatible with winch and Body Armor
- Standard front receiver hitch for additional functionality

» 2884850 • \$339⁹⁹

SPORTSMAN 450/570 '21-23



NEW BOOT GUARDS

- Made from High Density Poly Ethylene (HDPE)
- Comes with two front guards, one for the left and right
- Protects the CV boot

» 2890059 • \$99⁹⁹

SPORTSMAN 450/570 '21-23



BODY ARMOR

- Provides extra protection to your ATV's full body and fenders

» 2884851 • \$309⁹⁹

SPORTSMAN 450/570 '21-23

FRONT BUMPER (2884850 OR 2884844) REQUIRED FOR INSTALLATION

DOES NOT WORK WITH KOLPIN STRONGHOLD® AUTO-LATCH GUN MOUNT (2884846)



SKID PLATE

- Built to be tough from 10mm thick High Density Poly Ethylene (HDPE)

» 2884852 • \$409⁹⁹

SPORTSMAN 450/570 '21-23



RACKS

NEW CARGO RACK

- Provides extra storage and a sturdy platform for securing items to the back of your ATV
- Replaces your stock rear bumper while increasing your rack size by 33%
- Virtually limitless number of tie-down points
- Has a steel matte black finish

» 2890037 • \$499⁹⁹

SPORTSMAN 450/570 '21-23

WILL NOT WORK WITH REAR BUMPER;
SERVES AS REAR BUMPER / REAR CARGO RACK



REAR RACK EXTENDER TOP SELLER

- Forms a 3" tall perimeter around the rear cargo rack to keep gear secure which maximizes your cargo capabilities
- Durable steel construction provides a sturdy tie down anchor for loose gear
- Compatible with Cargo Boxes and Rear Utility Rack

» 2884841 • \$104⁹⁹

SPORTSMAN 450/570 '21-23



FRONT UTILITY RACK TOP SELLER

- Tubular steel rack that attaches on top of front plastic rack providing protection and multiple tie down points
- 3/4" diameter matte black steel tube

» 2884842 • \$134⁹⁹

SPORTSMAN 450/570 '21-23, EXCEPT '21 AND PRIOR 6X6,
X2 AND TOUR MODELS

DOES NOT WORK WITH KOLPIN STRONGHOLD®
AUTO-LATCH GUN MOUNT (2884846)



REAR UTILITY RACK TOP SELLER

- Replaces rear plastic rack with a strong flat steel rack with integrated tie down points
- Works with all Lock & Ride accessories, rack extenders, and gun mounts

» 2884843 • \$214⁹⁹

SPORTSMAN 450/570 '21-23



SPORTSMAN 450 • 570

COMFORT



HANDGUARDS

<input type="checkbox"/> BRIGHT WHITE	2876883	\$44 ⁹⁹
<input checked="" type="checkbox"/> BLACK <small>TOP SELLER</small>	2876846	\$44 ⁹⁹
<input type="checkbox"/> INDY RED	2876845	\$44 ⁹⁹

- Handguard Mount (2889341) is required when installing Polaris Handguards
- Does not fit with windshields or Handlebar Mounted Mirrors

» 2889341 • MOUNT • \$34⁹⁹
SPORTSMAN 450/570 '21-23



HAND & THUMB WARMER KIT TOP SELLER

- Provides heat to grips and throttle and is easily installed by plugging into pod
- Includes two heated grips and one throttle warmer

» 2885002 • \$104⁹⁹
SPORTSMAN 450/570 '21-23



HANDLEBAR MOUNTED MIRRORS TOP SELLER

- Enhances visibility of what's behind you for added safety
- Sold as a pair
- Does not fit with windshields or Handguards

» 2877222 • \$39⁹⁹
SPORTSMAN 450/570 '21-23



LED LIGHT KIT

- Upgrade your standard headlights and pod lights to LEDs with this upgrade kit

» 2884859 • \$409⁹⁹
SPORTSMAN 450/570 '21-23



REAR POWER HARNESS

- Provides power to the rear of the ATV for electrical accessories including Rear Audio Storage Box

» 2889070 • \$84⁹⁹
SPORTSMAN 450/570 '21-23

AUDIO



LOCK & RIDE REAR AUDIO STORAGE BOX

- Dual 6" speakers by Rockford Fosgate® that connect via Bluetooth®
- Mounts easily with Lock & Ride to the rear rack and is compatible with rack extenders, utility rack, and gun mount
- Rest easy knowing that your speakers are protected with a sealed-lid container
- Rear Power Harness required for installation (2889070)

» 2884856 • \$619⁹⁹
SPORTSMAN 450/570 '21-23



AUDIO STORAGE BOX REMOTE

- Easily control the volume or switch to the next song on your Rear Audio Storage Box
- Conveniently mounts to your ATV's handlebars

» 2884987 • \$94⁹⁹
SPORTSMAN 450/570 '21-23

STORAGE



POD BAG

- Keep your essentials in reach with 2 Liters of storage capacity
- Mounts to the top of the light pod with HD Velcro®
- Semi-rigid construction and PU Laminated EVA material keeps belongings protected from the elements
- Compatible with windshields

» 2889286 • \$74⁹⁹
SPORTSMAN 450/570 '21-23



FENDER BAG

- Provides easy-access 8.3 Liters of storage
- Mounts to the front left fender with HD Velcro®
- Semi-rigid construction and PU Laminated EVA material keeps belongings protected from the elements

» 2889287 • \$134⁹⁹
SPORTSMAN 450/570 '21-23



REAR RACK EXTENDER BAGS

- Three bags included (Rear Rack Extender sold separately)
- Mounts to Rear Rack Extender with HD Velcro®
- Add a convenient 1 Liter of storage without sacrificing the rear rack
- Made to withstand the elements and wear with durable ballistic nylon construction (1680 Nylon and 600D SPD)
- Rear Rack Extender (2884841) is required

» 2889411 • \$114⁹⁹
SPORTSMAN 450/570 '21-23

UNDERSEAT BAG

- Provides an extra 8.3 Liters of storage capacity
- Mounts directly under your seat via a Velcro® wrap
- Durable semi-rigid construction keeps items protected

» 2889454 • \$84⁹⁹
SPORTSMAN 450/570 '21-23



LOCK & RIDE REAR CARGO BOX

- Increase your storage with an extra 21.25 gallons of dry, dust-proof storage
- Mounts easily with Lock & Ride to the rear rack and is compatible with rack extenders, utility rack, and gun mount
- Includes 2 padlock locations

» 2884853 • \$349⁹⁹
SPORTSMAN 450/570 '21-23



LOCK & RIDE OPEN CARGO BOX

- Increase your storage with an extra 22 gallons of convenient storage space
- Mounts easily with Lock & Ride to the rear rack and is compatible with rack extenders, utility rack, and gun mount
- Holds two 5-gallon buckets with integrated grab handle to make it easy to carry and transport cargo
- 12 convenient tie-down locations to secure cargo

» 2884854 • \$214⁹⁹
SPORTSMAN 450/570 '21-23



LOCK & RIDE REAR COOLER BOX

- Increase your storage with an extra 46 quarts of weather resistant cooler storage
- Mounts easily with Lock & Ride to the rear rack and is compatible with rack extenders, utility rack, and gun mount
- Integrated bottle opener and 2 padlock locations

» 2884857 • \$409⁹⁹
SPORTSMAN 450/570 '21-23



SPORTSMAN 450 • 570



WINDSHIELDS



Tall 18" Clear
2884945



Mid 14" Clear
2884845



Tall 18" Clear
2889491

LOCK & RIDE WINDSHIELDS

- Lock & Ride technology allows for easy installation and removal in seconds without tools
- Poly windshields are flexible, impact-resistant, and provide long-term value over the life of your machine
- Two heights available for whatever coverage you prefer
- Does not work with Handguards or Handlebar Mounted Mirrors

SIZE	COLOR	PART #	PRICE
TALL 18"	CLEAR	2884945	\$184 ⁹⁹
MID 14"	CLEAR	2884845	\$174 ⁹⁹

SPORTSMAN 450/570 '21-'23

TALL 18"	CLEAR	2889491	\$179 ⁹⁹
----------	-------	---------	---------------------

SPORTSMAN 450/570 '23 WITH 7" DISPLAY INSTALLED



DO MORE

PLOWS P.34



WHEELS & TIRES P.38



LIGHTING P.44



HUNT P.46



SPORTSMAN

2014-2021
570_{X2}

2014-2022
570_{6X6}

570_{TOURING}



WINCHES

POLARIS HD 3,500 LB. WINCH TOP SELLER

» 2880434 • \$484⁹⁹
X2 570 '15-21, TOURING 570 '14-22, 6X6 570 '17-22



POLARIS HD 2,500 LB. WINCH TOP SELLER

» 2880432 • \$409⁹⁹
X2 570 '15-21, TOURING 570 '14-22, 6X6 570 '17-22



NEED A PLOW? SEE P. 34

STORAGE



SEMI-RIGID TOURING CARGO BAG

- Large-capacity, heavy-duty vinyl bag
- Three zippered openings, removable dividers
- Attaches to rack with Velcro® straps

» 2877220 • \$164⁹⁹
TOURING 570 '14-22

COMFORT



HAND WARMERS TOP SELLER

» 2877363 • \$64⁹⁹
X2 570 '15-21, TOURING 570 '14-22, 6X6 570 '17-22



THROTTLE/THUMB WARMER TOP SELLER

» 2877364 • \$49⁹⁹
X2 570 '15-21, TOURING 570 '14-22, 6X6 570 '17-22

HANDGUARDS

<input type="checkbox"/> BRIGHT WHITE	2876883	\$44 ⁹⁹
<input checked="" type="checkbox"/> BLACK <small>TOP SELLER</small>	2876846	\$44 ⁹⁹
<input checked="" type="checkbox"/> INDY RED	2876845	\$44 ⁹⁹

- Handguard Mount (2889341) is required when installing Polaris Handguards
- Does not fit with windshields or Handlebar Mounted Mirrors

» 2889341 • MOUNT • \$34⁹⁹
X2 570 '15-21, TOURING 570 '14-22, 6X6 570 '17-22



HANDLEBAR MOUNTED MIRRORS TOP SELLER

- Enhances visibility of what's behind you for added safety
- Sold as a pair
- Does not fit with Windshield Fairing or Handguards

» 2877222 • \$39⁹⁹
X2 570 '15-21, TOURING 570 '14-22, 6X6 570 '17-22

PROTECTION, RACKS & WINDSHIELDS



FRONT BRUSHGUARD TOP SELLER

» 2879714 • \$194⁹⁹
X2 570 '15-21, TOURING 570 '14-22, 6X6 570 '17-22



REAR BRUSHGUARD

» 2879715 • \$184⁹⁹
TOURING 570 '14-22



ULTIMATE SERIES FRONT RACK EXTENDER 4\"/>

» 2879716 • \$109⁹⁹
X2 570 '15-21, TOURING 570 '14-22, 6X6 570 '17-22



LOCK & RIDE YUKON ADVENTURE RACK

- Adds increased storage volume by allowing you to increase storage height securely

» 2882084 • \$319⁹⁹
6X6 570 '17-22

LOCK & RIDE WINDSHIELDS

- Lock & Ride technology allows for easy installation and removal in seconds without tools
- Poly windshields are flexible, impact-resistant, and provide long-term value over the life of your machine
- Does not work with Handguards

SIZE	COLOR	PART #	PRICE
TALL 19.25"	CLEAR	2880539-409	\$174 ⁹⁹
MID 15.5"	SMOKE	2880540-412	\$164 ⁹⁹

X2 570 '18-21, TOURING 570 '18-22



Tall 19.25" Clear



Mid 15.5" Smoke

COMFORT ESSENTIALS

Polaris Pro HD 3,500 lb. Winch	P. 24	LOCK & RIDE Rear Audio Storage Box	P. 27	Pro Armor Wheel & Tire Set: Dual Threat/4202	P. 43
Ultimate Series Rear Rack Extender	P. 24	Audio Storage Box Remote	P. 27	Lug Nuts	P. 43
Ultimate Series Front Brushguard	P. 25	Handguards	P. 27	RIGID® D-Series Pro Driving LED Light	P. 44
Ultimate Series Rear Brushguard	P. 25	Handguard Mount	P. 27	Lightbar Harness	P. 45
Pod Bag	P. 26	Rear Power Harness	P. 27	LED Y-Harness	P. 45

HUNTER

Polaris HD 3,500 lb. Winch	P. 24	LOCK & RIDE Tall Windshield	P. 28	Lightbar Harness	P. 45
Ultimate Series Rear Rack Extender	P. 24	Pro Armor Wheel & Tire Set: Mud XC/4205	P. 43	Gun Boot L	P. 46
Ultimate Series Front Brushguard	P. 25	Lug Nuts	P. 43	Stronghold Auto-Latch Mount	P. 46
Hand & Thumb Warmer Kit	P. 27	RIGID® SR-Series 10" Combo LED Light	P. 45	LOCK & RIDE Rhino Grip Pro	P. 47

WORK HARD AND GET IT DONE with Polaris Engineered Accessories.
Find everything you need to outfit your trusted partner for the task at hand.

WORKER

Polaris HD 2,500 lb. Winch	P. 24	Ultimate Series Rear Brushguard	P. 25	LOCK & RIDE Mid Windshield	P. 28
Ultimate Series Rear Rack Extender	P. 24	Ultimate Series Body Armor	P. 25	Pro Armor Wheel & Tire Set: Harvester/4204	P. 43
Ultimate Series Front Steel Rack	P. 25	LOCK & RIDE Open Cargo Box	P. 26	Lug Nuts	P. 43
Ultimate Series Front Brushguard	P. 25	Rear Power Harness	P. 27		

WINTER

Polaris Pro HD 3,500 lb. Winch	P. 24	Hand & Thumb Warmer Kit	P. 27	Glacier Pro Plow Blade - 66" Poly	P. 35
Ultimate Series Rear Rack Extender	P. 24	LOCK & RIDE Tall Windshield	P. 28	RIGID® SR-Series 10" Combo LED Light	P. 45
Ultimate Series Front Brushguard	P. 25	Glacier Integrated Plow Mount	P. 35	Lightbar Harness	P. 45
LOCK & RIDE Rear Cargo Box	P. 26	Glacier Pro Steel ATV Plow Frame	P. 35		

SPORTSMAN 850 XP 1000 XP 1000 S



WINCHES

POLARIS PRO HD 3,500 LB. WINCH

- » 2883580 • \$564⁹⁹
SPORTSMAN XP 1000 S '20-23
- » 2889471 • \$564⁹⁹
SPORTSMAN 850 '12-23, SPORTSMAN XP 1000 '15-23,
SPORTSMAN TOURING XP 1000 '15-23,
SPORTSMAN TOURING 850 '15-23

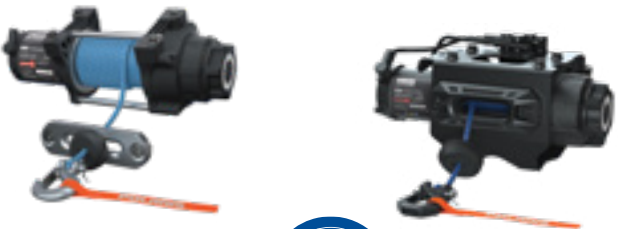

LEARN MORE
P. 10

POLARIS HD 3,500 LB. WINCH

- » 2889470 • \$484⁹⁹
SPORTSMAN 850 '12-23, SPORTSMAN XP 1000 '15-23,
SPORTSMAN TOURING XP 1000 '15-23,
SPORTSMAN TOURING 850 '15-23



POLARIS HD 2,500 LB. WINCH

- » 2889469 • \$409⁹⁹
SPORTSMAN 850 '12-23, SPORTSMAN XP 1000 '15-23,
SPORTSMAN TOURING XP 1000 '15-23,
SPORTSMAN TOURING 850 '15-23



NEED A PLOW? SEE P. 34

POLARIS.COM/ShopSPORTSMAN

RACKS

ULTIMATE SERIES RACK EXTENDER 4"

FRONT

- » 2882022 • \$109⁹⁹
SPORTSMAN XP 1000 S '20-23,
SPORTSMAN 850/1000 '17-23



REAR

- » 2882023 • \$119⁹⁹
SPORTSMAN XP 1000 S '20-23,
SPORTSMAN 850/1000 '17-23
FITS WITH REAR CARGO BOX (2882882)



ULTIMATE SERIES RACK EXTENDER 7"

FRONT

- » 2882024 • \$164⁹⁹
SPORTSMAN XP 1000 S '20-23,
SPORTSMAN 850/1000 '17-23
NOT SHOWN



REAR

- » 2882025 • \$169⁹⁹
SPORTSMAN XP 1000 S '20-23,
SPORTSMAN 850/1000 '17-23
DOES NOT FIT WITH REAR CARGO BOX (2882882)



FRONT RACK EXTENDER

- » 2879890 • \$109⁹⁹
SPORTSMAN 850/1000 TOURING '10-23
DOES NOT FIT WITH FRONT CARGO BOX (2877951)

ULTIMATE SERIES STEEL RACK

FRONT

- » 2883257 • \$164⁹⁹
SPORTSMAN XP 1000 S '20-23,
SPORTSMAN 850/1000 '17-23



REAR

- » 2883258 • \$214⁹⁹
SPORTSMAN XP 1000 S '20-23,
SPORTSMAN 850/1000 '17-23



ULTIMATE SERIES MOVEABLE TIE-DOWN POINTS

- » 2882270 • \$69⁹⁹
(FRONT & REAR - SOLD IN PAIRS)
SPORTSMAN 850/1000 '17-23



PROTECTION



ULTIMATE SERIES BRUSHGUARD

- Quick installation to the integrated mounting tubes on the vehicle using wedge-style expansion anchor mounts
- Attach the Body Armor to the Front Brushguard to provide the ultimate protection for the front fenders

- » 2882020 • FRONT • \$269⁹⁹ TOP SELLER
SPORTSMAN XP 1000 S '20-23,
SPORTSMAN 850/1000 '17-23

- » 2882583 • REAR • \$214⁹⁹ TOP SELLER
SPORTSMAN XP 1000 S '20-23,
SPORTSMAN 850/1000 '17-23



ULTIMATE SERIES BODY ARMOR

- Securely mounts to Ultimate Series Sportsman XP Front Brushguard (2882020)
- Comes as pair

- » 2882090 • \$329⁹⁹
SPORTSMAN 850/1000 '17-23
DOES NOT WORK WITH GUN BOOT MOUNT (2882036)



TOURING XP BRUSHGUARD

- Adds heavy-duty protection and a custom look

- » 2878709 • FRONT • \$234⁹⁹
SPORTSMAN 850/1000 TOURING '10-23

- » 2878324 • REAR • \$174⁹⁹
SPORTSMAN 850/1000 TOURING '10-23

SPORTSMAN

850

XP 1000

XP 1000 S

STORAGE



LOCK & RIDE REAR CARGO BOX

- Increase your storage with an extra 21.25 gallons of dry, dust-proof storage
- Mounts easily with Lock & Ride to the rear rack and is compatible with rack extenders and gun mount
- Includes 2 padlock locations
- Will not fit when Ultimate Series Steel Rack is installed

» 2884853 • \$349⁹⁹
SPORTSMAN XP 1000 S '20-23, SPORTSMAN 850/1000 '17-23



LOCK & RIDE OPEN CARGO BOX

- Increase your storage with an extra 22 gallons of convenient storage space
- Mounts easily with Lock & Ride to the rear rack and is compatible with rack extenders and gun mount
- Holds 2, 5-gallon buckets with integrated grab handle to make it easy to carry and transport cargo
- 12 convenient tie-down locations to secure cargo
- Includes 2 padlock locations
- Will not fit when Ultimate Series Steel Rack is installed

» 2884854 • \$214⁹⁹
SPORTSMAN XP 1000 S '20-23, SPORTSMAN 850/1000 '17-23



LOCK & RIDE REAR COOLER BOX

- Increase your storage with an extra 46 quarts of weather-resistant cooler storage space
- Mounts easily with Lock & Ride to the rear rack and is compatible with rack extenders and gun mount
- Integrated bottle opener and 2 padlock locations
- Will not fit with Ultimate Series Steel Rack

» 2884857 • \$409⁹⁹
SPORTSMAN XP 1000 S '20-23, SPORTSMAN 850/1000 '17-23

POD BAG

- Keep your essentials in reach with 2 Liters of storage capacity
- Mounts to the top of the light pod with HD Velcro®
- Semi-rigid construction and PU Laminated EVA material keeps belongings protected from the elements
- Compatible with windshields

» 2889286 • \$74⁹⁹
SPORTSMAN 850/1000 21-23



ULTIMATE SERIES READY PACK

- Keep your trail essentials at the ready with this easy-to-access, weather-resistant storage compartment

» 2882271 • \$64⁹⁹
SPORTSMAN 850/1000 '17-23



LOCK & RIDE FRONT CARGO BOX

» 2877951 • \$204⁹⁹
SPORTSMAN 850/1000 TOURING '10-23
FRONT RACK EXTENDER CANNOT BE INSTALLED AT THE SAME TIME AS FRONT CARGO BOX



LOCK & RIDE REAR STORAGE BOX

» 2878000 • \$229⁹⁹
SPORTSMAN 850/1000 TOURING '10-23
SLIGHT INTERFERENCE WITH SPORTSMAN TOURING 550/850 '11-14 PASSENGER HANDLES
DOES NOT FIT '21 TOURING MODELS

AUDIO



LOCK & RIDE REAR AUDIO STORAGE BOX

- Dual 6" speakers by Rockford Fosgate® that connect via Bluetooth®
- Mounts easily with Lock & Ride to the rear rack and is compatible with rack extenders and gun mount
- Rest easy knowing that your speakers are protected with a sealed-lid container
- Rear Power Harness (2889071) is required, sold separately

» 2884856 • \$619⁹⁹
SPORTSMAN XP 1000 S '20-23, SPORTSMAN 850/1000 '17-23



AUDIO STORAGE BOX REMOTE

- Easily control the volume or switch to the next song on your Rear Audio Storage Box
- Conveniently mounts to your ATV's handlebars

» 2884987 • \$94⁹⁹
SPORTSMAN XP 1000 S '20-23, SPORTSMAN 850/1000 '17-23

COMFORT



HANDLEBAR MOUNTED MIRRORS TOP SELLER

- Enhances visibility of what's behind you for added safety
- Sold as a pair
- Does not fit with Windshield Fairing or Handguards

» 2877222 • \$39⁹⁹
SPORTSMAN XP 1000 S '20-23, SPORTSMAN 850/1000 TOURING '10-23, SPORTSMAN 850/1000 '09-23



HANDGUARDS

<input type="checkbox"/> BRIGHT WHITE	2876883	\$44 ⁹⁹
<input checked="" type="checkbox"/> BLACK TOP SELLER	2876846	\$44 ⁹⁹
<input checked="" type="checkbox"/> INDY RED	2876845	\$44 ⁹⁹

- Handguard Mount (2889341) is required when installing Polaris Handguards
- Does not fit with windshield or Handlebar Mounted Mirrors

» 2889341 • MOUNT • \$34⁹⁹
SPORTSMAN XP 1000 S '20-23, SPORTSMAN 850/1000 TOURING '10-23, SPORTSMAN 850/1000 '09-23



HAND & THUMB WARMER KIT TOP SELLER

- Provides heat to grips and throttle and is easily installed by plugging into pod
- Includes two heated grips and one throttle warmer

» 2885002 • \$104⁹⁹
SPORTSMAN 850/1000 '21-23



HAND WARMERS TOP SELLER

» 2877363 • \$64⁹⁹
SPORTSMAN XP 1000 S '20, SPORTSMAN XP 1000 '15-20, SPORTSMAN 850 '15-20, SPORTSMAN TOURING XP 1000 '15-23, SPORTSMAN TOURING 850 '15-23



THROTTLE/THUMB WARMERS TOP SELLER

» 2877364 • \$49⁹⁹
SPORTSMAN XP 1000 S '20, SPORTSMAN XP 1000 '15-20, SPORTSMAN 850 '15-20, SPORTSMAN TOURING XP 1000 '15-23, SPORTSMAN TOURING 850 '15-23



REAR POWER HARNESS

- Provides power to the rear of the ATV for electrical accessories including Rear Audio Storage Box

» 2889071 • \$84⁹⁹
SPORTSMAN XP 1000 S '20-23, SPORTSMAN XP 1000 '17-23, SPORTSMAN 850 '17-23

SPORTSMAN 850 XP 1000 XP 1000 S



DO MORE

WINDSHIELDS

LOCK & RIDE WINDSHIELDS

- Provides enhanced protection from the elements and off-road hazards
- Easily installs and removes without tools utilizing Lock & Ride technology
- Improved mounting system for easier and quicker attachment and detachment

SIZE	COLOR	PART #	PRICE
TALL 18"	CLEAR	2884945	\$184 ⁹⁹
MID 14"	CLEAR	2884845	\$174 ⁹⁹

SPORTSMAN XP 1000 S '21-23, SPORTSMAN XP 1000 '21-23, SPORTSMAN 850 '21-23



Tall 18" Clear
2884945



Mid 14" Clear
2884845



Tall 18" Clear
2889491

LOCK & RIDE WINDSHIELDS

- Installs and removes in seconds without tools with Lock & Ride technology
- Poly windshields are flexible, impact-resistant, and provide long-term value over the life of your machine
- Does not work with Handguards

SIZE	COLOR	PART #	PRICE
TALL 19.25"	CLEAR	2880539-409	\$174 ⁹⁹
MID 15.5"	SMOKE	2880540-412	\$164 ⁹⁹

SPORTSMAN TOURING XP 1000 '15-23, SPORTSMAN TOURING 850 '15-23



Tall 19.25" Clear
2880539-409



Mid 15.5" Smoke
2880540-412



PLOWS

P. 34



WHEELS & TIRES

P. 38



LIGHTING

P. 44



HUNT

P. 46

SCRAMBLER 850 XP 1000 S



COMFORT



HANDGUARD

- Handguard Mount (2889341) is required when installing Polaris Handguards
- Does not fit with windshield or Handlebar Mounted Mirrors

SPORTSMAN XP 1000 S '20-23, SPORTSMAN 850/1000 TOURING '10-23, SPORTSMAN 850/1000 '09-23

<input type="checkbox"/> BRIGHT WHITE	2876883	\$44 ⁹⁹
<input checked="" type="checkbox"/> BLACK <small>TOP SELLER</small>	2876846	\$44 ⁹⁹
<input type="checkbox"/> INDY RED	2876845	\$44 ⁹⁹



» 2889341 • MOUNT • \$34⁹⁹

RACKS/STORAGE



LARGE REAR RACK

» 2879139 • \$174⁹⁹
SCRAMBLER XP 1000 S '20-23, SCRAMBLER XP 1000 '14-18, SCRAMBLER 850 '14-23
NOT COMPATIBLE WITH OGIO® BAG (2879925)



OGIO® BAG

» 2879925 • \$184⁹⁹
SCRAMBLER XP 1000 S '20-23, SCRAMBLER XP 1000 '14-18, SCRAMBLER 850 '14-23

PROTECTION



ULTIMATE SPORT SERIES FRONT BRUSHGUARD

» 2883595 • \$259⁹⁹
SCRAMBLER XP 1000 S '20-23



FRONT BRUSHGUARD

» 2879136 • \$214⁹⁹
SCRAMBLER 850 '14-23, SCRAMBLER XP 1000 '14-18
REPLACES EXISTING LOWER BUMPER – WILL NOT WORK TOGETHER

WINCHES

POLARIS PRO HD 3,500 LB. WINCH



» 2883580 • \$564⁹⁹
SCRAMBLER XP 1000 S '20-23

POLARIS HD 3,500 LB. WINCH



» 2889470 • \$484⁹⁹
SCRAMBLER 850 '14-23, SCRAMBLER XP 1000 '14-18

POLARIS HD 2,500 LB. WINCH



» 2889469 • \$409⁹⁹
SCRAMBLER 850 '14-23, SCRAMBLER XP 1000 '14-18

MISCELLANEOUS ACCESSORIES



RIDE & REPAIR ESSENTIALS KIT

- 12-volt DC portable air compressor
- Tire repair kit with 6 plugs
- Basic first-aid kit with bandages, scissors, safety pins, and more
- 12-volt jumper cables
- Duct tape – 300mm x 1 roll
- Zip ties – 150mm length
- Electrical tape
- Ratchet strap – 50mm
- Microfiber cloth
- Carry bag

» 2881207 • \$109⁹⁹



QUICKTAP BATTERY POSTS

- Easy-to-access terminal posts give you quick access to the battery power
- Ideal for charging your battery, powering a temporary accessory, or when you need to offer an unexpected jump-start
- Connection posts feature covers to protect terminals when not in use

» 2882110 • \$59⁹⁹



ATV LICENSE PLATE

- Includes numbers and letters
- » 2873270 • \$14⁹⁹

TRAILERING AND RECOVERY STRAPS

SEE P. 63

YOUTH ATV OUTLAW 70 EFI

THE PERFECT FIRST ALL-TERRAIN VEHICLE FOR
KIDS STARTING AT 6 YEARS AND OLDER



FRONT BRUSHGUARD

- Provides enhanced protection from brush and other debris on the trail

» 2884567 • \$124⁹⁹
OUTLAW 70 EFI '21-23



REAR BRUSHGUARD

- Protect the rear of your youth ATV from hazards on the trails

» 2884778 • \$44⁹⁹
OUTLAW 70 EFI '21-23



WINDSHIELD - POLY

- Added wind and hand protection with a durable poly design

» 2885005 • \$104⁹⁹
OUTLAW 70 EFI '21-23

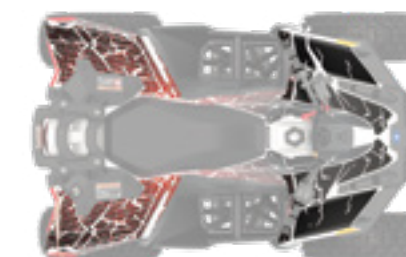

DECAL KIT - INDY RED

- Replaces the stock Outlaw 70 decals to provide a unique and custom look for your youth ATV

» 2885107 • \$94⁹⁹
OUTLAW 70 EFI '21-23



REAR STORAGE BAG

- Convenient storage that easily connects to the rear rack

» 2884555 • \$64⁹⁹
OUTLAW 70 EFI '21-23



PLOW SYSTEM

TAKE COMMAND OF
CLEARING SNOW AND
MAKE QUICK WORK OF
EVEN THE HEAVIEST JOBS.

THE POLARIS ENGINEERED ADVANTAGE

INSTALLATION

30 seconds: Drive up, clip in, lock down, and go — the integrated Polaris Engineered Glacier Plow System simplifies plowing.



CONVENIENCE

Lift and angle adjustments can be made from the driver's seat.

ANGLE YOUR BLADE
RIGHT FROM YOUR SEAT
with the Glacier Pro
plow hydraulic
angle system



ROBUST FRAME

A plow system is only as strong as its frame, and Polaris Engineered plow frames have a wide frame to withstand the rigors of heavy plowing.



DURABLE BLADES

Available in strong stamped steel or corrosion-resistant poly materials, Polaris Engineered plow blades cover a large surface area for quick snow removal.

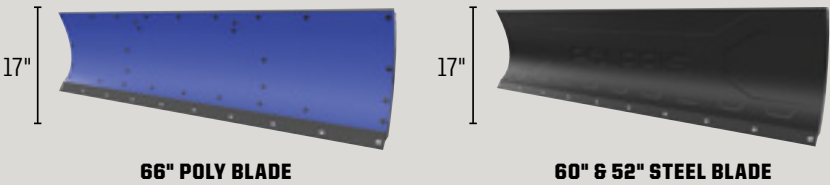

66" POLY BLADE

60" & 52" STEEL BLADE

PLOW SYSTEMS (WINCH REQUIRED, SOLD SEPARATELY)

Choose a Glacier Plow System, designed to help you get the most out of your Sportsman during snowy months. Select a system based on your plowing needs with premium add-ons including a hydraulic lift system or additional plow accessories.

GLACIER PRO HD PLOW SYSTEM WITH HYDRAULICS

System includes:
• Mount (2881424)
• Frame (2879630)
• 66" Poly Plow (2880269)
• Hydraulic Angle (2879635)
• Hydraulic Controller (2880836)
• Plow Markers (2872726)
• Plow Deflector (2879866)

» 3880010 • \$1,749⁹⁹
450 '15-23, 570 '15-23, 6X6 570 '17-22, X2 570 '15-21, 570 TOURING '15-22
REQUIRES LIFT METHOD: SEE WINCHES BELOW

GLACIER PRO HD PLOW SYSTEM

System includes:
• Mount (2881424)
• Frame (2879630)
• 60" Steel Plow (2879638)

» 3880011 • \$764⁹⁷
450 '15-23, 570 '15-23, 6X6 570 '17-22, X2 570 '15-21, 570 TOURING '15-22
REQUIRES LIFT METHOD: SEE WINCHES BELOW

GLACIER PRO HD PLOW SYSTEM WITH HYDRAULICS

System includes:
• Mount (2881423)
• Frame (2879630)
• 66" Poly Plow (2880269)
• Hydraulic Angle (2879635)
• Hydraulic Controller (2880836)
• Plow Markers (2872726)
• Plow Deflector (2879866)

» 3880012 • \$1,749⁹⁹
XP 1000 '15-23, 850 '15-23, TOURING 1000 '15-23, TOURING 850 '15-23, SCRAMBLER 850 '15-23
REQUIRES LIFT METHOD: SEE WINCHES BELOW

GLACIER PRO HD PLOW SYSTEM

System includes:
• Mount (2881423)
• Frame (2879630)
• 60" Steel Plow (2879638)

» 3880013 • \$764⁹⁷
XP 1000 '15-23, 850 '15-23, TOURING 1000 '15-23, TOURING 850 '15-23, SCRAMBLER 850 '15-23
REQUIRES LIFT METHOD: SEE WINCHES BELOW



GLACIER PRO HD
GIVES YOU:

66", 60" or
52" Blades

Choice of poly
or steel

Ability to add a
hydraulic angle system

	MANDATORY STEPS				OPTIONAL
	STEP 1 SELECT A MOUNT	STEP 2 SELECT A FRAME	STEP 3 SELECT PLOW CONFIGURATION		STEP 4 ADD HYDRAULICS
MODELS	MOUNT	FRAME	WINCHES	BLADES	HYDRAULICS
XP 1000 '15-23 850 '15-23 850/XP 1000 HIGHLIFTER '16-23 TOURING XP 1000 '15-23 TOURING 850 '10-23 SCRAMBLER 850 '14-23	<div>TOP SELLER</div> 2881423 \$184 ⁹⁹	<div>TOP SELLER</div> 2879630 \$299 ⁹⁹	Polaris Pro HD 3,500 lb. Winch 2889471 \$564 ⁹⁹ Polaris HD 3,500 lb. Winch 2889470 \$484 ⁹⁹ Polaris HD 2,500 lb. Winch 2889469 \$409 ⁹⁹	66" Poly 2880269 \$459 ⁹⁹ <div>TOP SELLER</div> 60" Steel 2879638 \$299 ⁹⁹ <div>TOP SELLER</div> 52" Steel 2879639 \$259 ⁹⁹	Hydraulic Plow Blade Angle System 2879635 \$639 ⁹⁹ Power Controller 2880836 \$109 ⁹⁹ <small>POWER CONTROLLER RECOMMENDED</small>
XP 1000 S '20-23 SCRAMBLER XP 1000 S '20-23	2883581 \$184 ⁹⁹		Polaris Pro HD 3,500 lb. Winch 2883580 \$564 ⁹⁹		
570 '15-20 6X6 570 '17-22 X2 570 '15-21 TOURING 570 '14-22 450 H.O. '12-20	<div>TOP SELLER</div> 2881424 \$184 ⁹⁹		Polaris HD 3,500 lb. Winch <div>TOP SELLER</div> 2880434 \$484 ⁹⁹ Polaris HD 2,500 lb. Winch <div>TOP SELLER</div> 2880432 \$409 ⁹⁹		
570 '21-23 450 H.O. '21-22			Polaris Pro HD 3,500 lb. Winch <div>TOP SELLER</div> 2884834 \$564 ⁹⁹ Polaris HD 3,500 lb. Winch <div>TOP SELLER</div> 2884833 \$484 ⁹⁹ Polaris HD 2,500 lb. Winch <div>TOP SELLER</div> 2884832 \$409 ⁹⁹		

STEP 5 SELECT ACCESSORIES AND REPLACEMENT ITEMS

66" HD Wear Bar 2879868 \$109 ⁹⁹ 66" Wear Bar 2879867 \$59 ⁹⁹ 60" Wear Bar 2877243 \$39 ⁹⁹ 52" Wear Bar 2877210 \$39 ⁹⁹	66" Plow Blade Snow Deflector 2879866 \$89 ⁹⁹ 60" Plow Blade Deflector 2871808 \$69 ⁹⁹ Skid Shoe 2208864 \$29 ⁹⁹ Glacier Pro Shear Pin Replacement 2205063 \$19 ⁹⁹ Coil Spring Spacer 2872655 \$24 ⁹⁹	Plow Winch Rope For 2,500 lb. & 3,500 lb. winches 2878483 \$34 ⁹⁹ Glacier Plow Marker Sold in pairs 2872726 \$39 ⁹⁹ Rear Tire Chains Recommended for rear tires only 2881422 \$109 ⁹⁹ Plow Blade Track Extension Required for track equipped vehicles 2879719 \$194 ⁹⁹
--	--	---

CHOOSE A PLOW SYSTEM

BUILD A PLOW SYSTEM

COMMON

WINCHES

450 - 570

850 - XP 1000 -
XP 1000 S

SCRAMBLER
850 - XP 1000 S

MISC & YOUTH

PLOW & TRACKS

WHEELS & TIRES

LIGHTING

HUNT & COOLERS

ALL-TERRAIN TRACTION

It's tough to make Sportsman even more versatile than it already is. But with a set of Prospector Pro® Tracks, you'll do just that. Tread through deep snow without concern.

Polaris-specific gearing provides 1:1 ratio to:

- Minimize track slip, providing better climbing ability and improved traction in deep snow
- Improve top speed over prior models by approximately 5%
- Reduce operating RPM for a quieter ride
- Improve driveline durability, which allows vehicle to run at a lower RPM, decreasing engine wear

Polaris exclusive optimized hub geometry that minimizes feedback and eases steering effort

Lightweight design provides for better flotation, eases steering effort, and provides better vehicle control

Flexible lug design provides the highest level of deep snow performance by lifting up in deep snow as opposed to digging down

New front dual stabilizer for improved stability

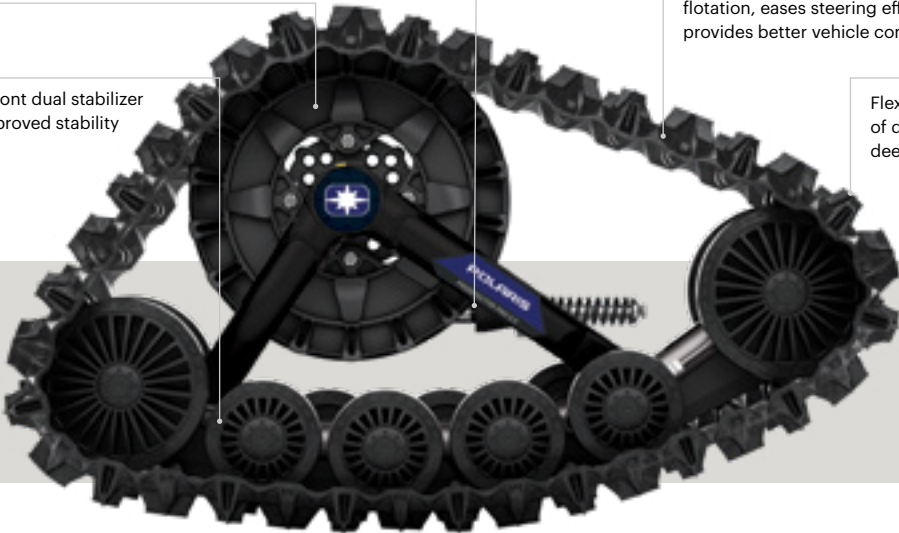

PROSPECTOR PRO 2.0 TRACK SYSTEM

STEP 1: SELECT A MOUNT KIT		
MODELS	A-ARMS	MOUNT KIT
SPORTSMAN XP 1000/850 '15-23 SPORTSMAN TOURING XP 1000/850 '15-23	STRAIGHT	2879457 \$454 ⁹⁹
SPORTSMAN XP 1000/850 '16-23 HIGHLIFTER 1000/850 '16-23	ARCHED	2882109 \$454 ⁹⁹
SPORTSMAN XP 1000 S '20-23 SCRAMBLER XP 1000 S '20-23	ARCHED	2883977 \$454 ⁹⁹
SPORTSMAN 570 '21-23	ARCHED	2889218 \$454 ⁹⁹
SPORTSMAN 570 '21-23	STRAIGHT	2889219 \$454 ⁹⁹
SPORTSMAN 570 '15-23 SPORTSMAN TOURING 570 '15-22 SPORTSMAN X2 570 '15-21	STRAIGHT	2879497 \$454 ⁹⁹

STEP 2: SELECT A TRACK KIT		
MODELS	EPS	TRACK KIT
SPORTSMAN 570 '15-23 SPORTSMAN TOURING 570 '15-22 SPORTSMAN X2 570 '15-21	YES	2889493 \$4,429 ⁹⁹
SPORTSMAN XP 1000/850 '15-23 SPORTSMAN TOURING XP 1000/850 '17-23 HIGHLIFTER 1000 '16-23 SPORTSMAN XP 1000 S '20-23 SCRAMBLER XP 1000 S '20-23	YES	2889495 \$4,429 ⁹⁹
SPORTSMAN 570 '14-23 SPORTSMAN TOURING 570 '15-22	NO	2889492 \$4,429 ⁹⁹
SPORTSMAN XP 1000 '18-23 SPORTSMAN 850 '15-23 SCRAMBLER 850 '13-23	NO	2889494 \$4,429 ⁹⁹

TRACK AND MOUNT KIT		
MODELS	EPS	TRACK AND MOUNT KIT
SPORTSMAN 570 6X6 '17-22	YES	2882169 \$6,179 ⁹⁹

WANT TO PLOW?

GLACIER PRO PLOW TRACK EXTENSION

- Plow extension for use when using the Prospector Pro Track System and Glacier Pro Sportsman plow system

» 2879719 • \$194⁹⁹
FOR USE WITH GLACIER PRO PLOW SYSTEMS



SPORTSMAN SNOW TRACTION OPTIONS

TREAD THROUGH SNOW WITH THESE OPTIONS	CONTACT PATCH	TURNING RADIUS
 STOCK TIRES	GOOD 	139.5" 
 PRO ARMOR WHITEOUT	BETTER  More surface area for better flotation on snow	138.875" 
 PROSPECTOR PRO® 2.0 TRACKS	BEST  Less aggressive tread displaces snow for better handling	175.375" 



- Tread patterns optimized for extreme traction
- Ideal for both hard pack and loose trail



- Flexible "grippy" tread
- Aggressive side bite



- Provides traction and durability
- Built to perform in hard sand, jagged rocks or any other extreme terrain



- Extra deep treads
- Self-cleaning lugs



- Paddles provide traction and durability in soft sand
- Built to float on top of sand



- Triple-belted sidewalls to resist puncture
- Purpose-built, long lasting tread patterns



- Handles extreme cold
- Holds shape and provides traction

SUPERIOR PERFORMANCE & DURABILITY

WAYS TO SHOP WHEELS & TIRES



LIFELONG PERFORMANCE

- Every tire is designed and constructed with longevity in mind
- 3,000+ mile rated (4,828 kilometers)

PREMIUM PROTECTION

- Pro Armor makes tires with extra protection exactly where it's needed most — the sidewall
- Triple-belted sidewalls keep your tires more resistant so you can keep going

TOUGH TIRES

- Higher ply ratings mean added protection
- Pro Armor builds 8 or 10-ply rated tires for higher puncture-resistance



KNOW YOUR TIRES

DIMENSIONS			TREAD DEPTH	TIRE WEIGHT	PLY RATING	SIDEWALL BELTS	LOAD RATING
TIRE HEIGHT	TIRE WIDTH	WHEEL DIAMETER					
32" x 9"	R15	FRONT/REAR	30 mm	41 LBS	10	3	1,320 LBS
Part Number • Price							
USAGE Where can you use the tire			TREAD DEPTH Deeper treads have more grip in all conditions		PLY RATING Indicates tire puncture-resistance		LOAD RATING How much weight can the tire handle
			TIRE WEIGHT A lighter tire makes for improved vehicle performance		SIDEWALL BELTS Increase your resistance to sidewall punctures		

TIRES BY SIZE

26"	27"
ATTACK	HARVESTER
DUAL-THREAT	MUD XC
HARVESTER	PRESERVE
PRESERVE	WHITEOUT
XD-K	X TERRAIN

TIRES BY TERRAIN

TRAIL	ROCK	DESERT	MUD	UTILITY	SNOW
ATTACK	ATTACK	ATTACK	MUD XC	ATTACK	ATTACK
DUAL-THREAT	DUAL-THREAT	DUAL-THREAT		HARVESTER	HARVESTER
HARVESTER				PRESERVE	PRESERVE
MUD XC				XD-K	XD-K
PRESERVE				X TERRAIN	WHITEOUT
X TERRAIN					
XD-K					

TIRES



PRO ARMOR DUAL-THREAT

- Dual-compound technology and radial construction offer performance in all terrains
- Softer durometer rubber on outer edge for overall superior grip and feel
- Harder durometer rubber in the middle for increase traction during acceleration and longer tread life

			TREAD DEPTH	TIRE WEIGHT	PLY RATING	SIDEWALL BELTS	LOAD RATING
14"	26" x 9" R14	FRONT	16 mm	27 lbs	10	3	910 lbs
	5416340 • \$179 ⁹⁹						
14"	26" x 11" R14	REAR		30 lbs			1,100 lbs
	5416341 • \$189 ⁹⁹						



WHEEL SIZE
14"



PRO ARMOR ATTACK

- The best all-purpose tire for all-season traction in any terrain
- Unique full-face tread design
- Harder durometer lugs promote extended wear, increasing tire life

			TREAD DEPTH	TIRE WEIGHT	PLY RATING	SIDEWALL BELTS	LOAD RATING
14"	26" x 9" R14	FRONT	23 mm	28 lbs	8	3	910 lbs
	5415613 • \$154 ⁹⁹						
14"	26" x 11" R14	REAR		32 lbs			1,320 lbs
	5415614 • \$169 ⁹⁹						



WHEEL SIZE
14"

TIRES



PRO ARMOR HARVESTER

- All-around workhorse with tread life of 5,000 miles / 8,047 kilometers
- Tread pattern designed to withstand anything from the farmyard to the pastures to the trail
- With 10-ply, it can carry the load day-in and day-out

			TREAD DEPTH	TIRE WEIGHT	PLY RATING	SIDEWALL BELTS	LOAD RATING
12"	26" x 8" R12 5416396 • \$189 ⁹⁹	FRONT		24 lbs			855 lbs
12"	26" x 10" R12 5415966 • \$199 ⁹⁹	REAR	16 mm	32 lbs	10	3	1,320 lbs
14"	27" x 10" R14 5415965 • \$199 ⁹⁹	FRONT/REAR		32 lbs			1,320 lbs



PRO ARMOR PRESERVE

- Turf-friendly for areas where low impact from tire tread is needed
- Exceptionally quiet-running and low impact

			TREAD DEPTH	TIRE WEIGHT	PLY RATING	SIDEWALL BELTS	LOAD RATING
12"	26" x 8" R12 5416403 • \$189 ⁹⁹	FRONT		29 lbs			1,320 lbs
12"	26" x 10" R12 5416402 • \$199 ⁹⁹	REAR	16 mm	28 lbs	10	3	1,320 lbs
14"	27" x 10" R14 5416348 • \$199 ⁹⁹	FRONT/REAR		24 lbs			855 lbs



PRO ARMOR XD-K

- 26" Aramid fiber-belted tire can tackle any terrain
- Unique full-face tread design
- Harder durometer lugs promote extended wear, increasing tire life

			TREAD DEPTH	TIRE WEIGHT	PLY RATING	SIDEWALL BELTS	LOAD RATING
12"	26" x 9" R12 5415756 • \$227 ⁹⁹	FRONT		28 lbs		3/1 Aramid	935 lbs
12"	26" x 11" R12 5415757 • \$269 ⁹⁹	REAR	31.7 mm	32 lbs	8		1,330 lbs



PRO ARMOR WHITEOUT

- Extra wide tires for flotation in snow
- Tread pattern designed for superior snow traction with limited digging

			TREAD DEPTH	TIRE WEIGHT	PLY RATING	SIDEWALL BELTS	LOAD RATING
14"	27" x 14" R14 5416032 • \$294 ⁹⁹	FRONT/REAR	16 mm	24 lbs	8	3	935 lbs



NEW X TERRAIN

- Built to perform through the toughest obstacles on any trail
- Durability-driven design to provide a comfortable, confident ride
- 8-ply, triple-belted ballistic sidewalls resist punctures

			TREAD DEPTH	TIRE WEIGHT	PLY RATING	SIDEWALL BELTS	LOAD RATING
14"	27" x 9" R14 5418330 • \$159 ⁹⁹	FRONT		26 lbs			805 lbs
14"	27" x 11" R14 5418331 • \$169 ⁹⁹	REAR	16 mm	31 lbs	8	3	965 lbs



PRO ARMOR MUD XC

- Designed as the perfect mud-trail crossover for a smooth ride on the trail and aggressive traction in the mud
- Dual-compound technology with harder durometer lugs promotes extended wear, increasing tire life
- 10-ply construction means added protection in the toughest terrain

			TREAD DEPTH	TIRE WEIGHT	PLY RATING	SIDEWALL BELTS	LOAD RATING
14"	27" x 9" R14 5416947 • \$199 ⁹⁹	FRONT		30 lbs			1,170 lbs
14"	27" x 11" R14 5416948 • \$209 ⁹⁹	REAR	30 mm	32 lbs	10	3	1,320 lbs



COMMON

WINCHES

450-570

850-XP1000-
XP1000 S

SCRAMBLER
850-XP1000 S

MISC & YOUTH

PLOW & TRACKS

WHEELS & TIRES

LIGHTING

HUNT & COOLERS

WHEELS



A 4101
WEIGHT: 14.5 lbs LOAD RATING: 800 lbs OFFSET: -35

MATTE BLACK:	FRONT/REAR	14" × 10"	1522958	\$189 ⁹⁹
--------------	------------	-----------	---------	---------------------

D 4203 BEADLOCK

FRONT	WEIGHT: 13 lbs	LOAD RATING: 900 lbs	OFFSET: +4
REAR	WEIGHT: 14.5 lbs	LOAD RATING: 1300 lbs	OFFSET: -9

MATTE BLACK:	FRONT	14" × 7"	1522238-458	\$229 ⁹⁹
	REAR	14" × 8"	1522239-458	\$229 ⁹⁹

G 4206

FRONT	WEIGHT: 9.5 lbs	LOAD RATING: 900 lbs	OFFSET: +4
REAR	WEIGHT: 10.75 lbs	LOAD RATING: 1300 lbs	OFFSET: -9

MATTE BLACK:	FRONT	14" × 6"	1522542-458	\$129 ⁹⁹
	REAR	14" × 8"	1522543-458	\$139 ⁹⁹

B 4201

FRONT	WEIGHT: 13 lbs	LOAD RATING: 900 lbs	OFFSET: +9
REAR	WEIGHT: 14 lbs	LOAD RATING: 1300 lbs	OFFSET: +9

ACCENT:	FRONT	14" × 7"	1522956-266	\$154 ⁹⁹
	REAR	14" × 8"	1522957-266	\$169 ⁹⁹

MATTE BLACK:	FRONT	14" × 7"	1522956-458	\$129 ⁹⁹
	REAR	14" × 8"	1522957-458	\$139 ⁹⁹

E 4204

FRONT	WEIGHT: 13 lbs	LOAD RATING: 900 lbs	OFFSET: +4
REAR	WEIGHT: 14 lbs	LOAD RATING: 1300 lbs	OFFSET: -9

ACCENT:	FRONT	14" × 7"	1522546-266	\$154 ⁹⁹
	REAR	14" × 8"	1522547-266	\$154 ⁹⁹

MATTE BLACK:	FRONT	14" × 7"	1522546-458	\$129 ⁹⁹
	REAR	14" × 8"	1522547-458	\$129 ⁹⁹

H 4301 BEADLOCK

WEIGHT: 16 lbs	LOAD RATING: 1600 lbs	OFFSET: +38
----------------	-----------------------	-------------

ACCENT:	FRONT/REAR	14" × 7"	1523284	\$219 ⁹⁹
---------	------------	----------	---------	---------------------

MATTE BLACK:	FRONT/REAR	14" × 7"	1523283	\$209 ⁹⁹
--------------	------------	----------	---------	---------------------

C 4202

FRONT	WEIGHT: 12.75 lbs	LOAD RATING: 900 lbs	OFFSET: +4
REAR	WEIGHT: 13.5 lbs	LOAD RATING: 1300 lbs	OFFSET: -9

ACCENT:	FRONT	14" × 7"	1522544-266	\$154 ⁹⁹
	REAR	14" × 8"	1522545-266	\$169 ⁹⁹

MATTE BLACK:	FRONT	14" × 7"	1522544-458	\$129 ⁹⁹
	REAR	14" × 8"	1522545-458	\$139 ⁹⁹

F 4205

FRONT	WEIGHT: 10.5 lbs	LOAD RATING: 900 lbs	OFFSET: +4
REAR	WEIGHT: 12.5 lbs	LOAD RATING: 1300 lbs	OFFSET: -9

MATTE BLACK:	FRONT	14" × 7"	1521507-521	\$119 ⁹⁹
	REAR	14" × 8"	1521508-521	\$129 ⁹⁹

LUSTER:	FRONT	14" × 7"	1521507-410	\$154 ⁹⁹
	REAR	14" × 8"	1521508-410	\$159 ⁹⁹

I HD DUAL BEADLOCK

WEIGHT: 40 lbs	LOAD RATING: 1,600 lbs	OFFSET: +38
----------------	------------------------	-------------

MATTE BLACK:	FRONT/REAR	14" × 7"	1524022-458	\$283 ⁹⁹
--------------	------------	----------	-------------	---------------------

KNOW YOUR WHEELS

STEP 1: SELECT SERIES

4 = 40-SERIES

STEP 2: CHOOSE LOAD RATING

1 = <800 LBS

2 = 801 - 1,300 LBS

3 = 1,301 - 1,600+ LBS

STEP 3: PICK STYLE

OFFSET / BEADLOCK / COLOR

INCREASE OFFSET FROM STOCK = NARROWER STANCE

DECREASE OFFSET FROM STOCK = WIDER STANCE

2 WAYS TO PURCHASE

INDIVIDUAL WHEELS & TIRES
- OR -
COMPLETE SETS AS LISTED

VISIT Polaris.com/ProArmorSPORTSMAN TO BUILD YOUR CUSTOM SET & VERIFY FITMENT

Exclusively at Polaris Authorized Dealers or Polaris.com/ProArmorSPORTSMAN

14" FORGED BEADLOCK RINGS

Sold Individually

A Machined

Only used on 4203 Beadlock & HD Dual Beadlock

1522244-266
124⁹⁹

B Beadlock Ring - Matte Black - 14"

Only used on 4301 Beadlock & HD Dual Beadlock

1523146-458
\$59⁹⁹

KNOW YOUR TERRAIN

TRAIL

- Tread patterns optimized for extreme traction
- Ideal for both hard pack and loose trail

MUD

- Extra deep treads
- Self-cleaning lugs

UTILITY

- Triple-belted sidewalls to resist puncture
- Purpose-built, long lasting tread patterns

SNOW

- Handles extreme cold
- Holds shape and provides traction

WHEEL & TIRE SETS

	14"	TRAIL	MUD	UTILITY	SNOW			
	40-SERIES	NEW X TERRAIN 27"	ATTACK 26"	DUAL-THREAT 26"	MUD XC 27"	PRESERVE 27"	HARVESTER 27"	WHITEOUT 27"
4101 Matte Black								2882382 \$1,954 ⁹⁹
4201 Accent		2889966 \$1,299 ⁹⁹	2882390 \$1,299 ⁹⁹	2883138 \$1,354 ⁹⁹	2884272 \$1,419 ⁹⁹	2883208 \$1,404 ⁹⁹	2882388 \$1,404 ⁹⁹	
4201 Matte Black		2889967 \$1,199 ⁹⁹	2882391 \$1,194 ⁹⁹	2883139 \$1,249 ⁹⁹	2884273 \$1,309 ⁹⁹	2883209 \$1,299 ⁹⁹	2882389 \$1,299 ⁹⁹	
4202 Accent		2889968 \$1,299 ⁹⁹	2881335 \$1,299 ⁹⁹	2883140 \$1,354 ⁹⁹	2884267 \$1,419 ⁹⁹		2882383 \$1,404 ⁹⁹	
4202 Matte Black		2889969 \$1,199 ⁹⁹	2881336 \$1,194 ⁹⁹	2883141 \$1,249 ⁹⁹	2884268 \$1,309 ⁹⁹	2883204 \$1,299 ⁹⁹	2882384 \$1,299 ⁹⁹	
4203 BEADLOCK Matte Black BEADLOCKS SOLD SEPARATELY		2889972 \$1,499 ⁹⁹	2881381 \$1,354 ⁹⁹					
4204 Accent		2889973 \$1,199 ⁹⁹	2881347 \$1,299 ⁹⁹	2883142 \$1,354 ⁹⁹	2884270 \$1,419 ⁹⁹	2883205 \$1,404 ⁹⁹	2882385 \$1,404 ⁹⁹	
4204 Matte Black		2889974 \$1,099 ⁹⁹	2881348 \$1,194 ⁹⁹	2883143 \$1,249 ⁹⁹	2884271 \$1,309 ⁹⁹		2882386 \$1,299 ⁹⁹	
4205 Luster			2881359 \$1,299 ⁹⁹	2883144 \$1,249 ⁹⁹				
4205 Matte Black		2889975 \$1,099 ⁹⁹	2881360 \$1,194 ⁹⁹	2883145 \$1,249 ⁹⁹	2884269 \$1,299 ⁹⁹	2883207 \$1,299 ⁹⁹	2882387 \$1,299 ⁹⁹	
4206 Matte Black			2881404 \$1,194 ⁹⁹					
4301 BEADLOCK Accent BEADLOCKS PRE-MOUNTED		2889970 \$1,499 ⁹⁹		2883217 \$1,679 ⁹⁹				
4301 BEADLOCK Matte Black BEADLOCKS PRE-MOUNTED		2889971 \$1,399 ⁹⁹		2883216 \$1,574 ⁹⁹				

LUG NUTS
LUG NUTS REQUIRED

METRIC LUG NUTS FOR ALUMINUM RIMS

- » 2877385 • SET OF 4 • \$14⁹⁹
- » 2877384 • SET OF 16 • \$34⁹⁹ SPORTSMAN XP

SAE LUG NUTS FOR ALUMINUM RIMS

- » 2876754 • SET OF 4 • \$14⁹⁹
- » 2877409 • SET OF 16 • \$34⁹⁹ SPORTSMAN 450/570

REPLACEMENT CAPS

LUSTER	ALL WHEELS EXCEPT 4204 & 4203 BEADLOCK	1521509-410 • \$14 ⁹⁹
MATTE BLACK		1521509-521 • \$14 ⁹⁹
HD MATTE BLACK	ALL WHEELS	5457498-458 • \$22 ⁹⁹

PRO ARMOR CENTER CAP		
LUSTER	ALL WHEELS EXCEPT 4204 & 4203 BEADLOCK	5453209-410 • \$14 ⁹⁹
MATTE BLACK		5453209-458 • \$14 ⁹⁹

TIRE SEALANT

P. 62

- » 32 OZ. • 2830484 • \$20⁹⁹
- » 1 GALLON • 2830485 • \$72⁹⁹
- » 5 GALLONS • 2830486 • \$298⁹⁹
- » 5 GALLONS PUMP • 2830487 • \$133⁹⁹

COLBY VALVE SHORT ULTIMATE VALVE - 2 PACK

» 2883292 • \$29⁹⁹

COLBY VALVE EMERGENCY VALVE - 2 PACK

» 2883293 • \$29⁹⁹

COLBY COMBO VALVE KIT - 16 PACK

• Includes eight Ultimate Valves and eight Emergency Valves

» 2883294 • \$464⁹⁹

COMMON

WINCHES

450 - 570

850 - XP1000 • XP1000 S

SCRAMBLER 850 • XP1000 S

MISC & YOUTH

PLOW & TRACKS

WHEELS & TIRES

LIGHTING

HUNT & COOLERS

43



POLARIS ENGINEERED
ADVANTAGES

MOUNTS PERFECTLY
Designed for your Polaris Engineered
bumper, roof or other mounting point

MAX PERFORMANCE
Validated to work as hard as
your machine does

DOESN'T OVERTAX
Trust it to work when
you need it to



ADVANCED
TECH

RIGID® lights are driven by Aluminum PCB Smart Boards®, 6063-T5 aircraft aluminum extruded housings and Tiger Drylac® UV protection polyester powdercoating.

EXCLUSIVE
OPTICS

RIGID® lights feature impact-resistant polycarbonate lenses for a 100% water/dustproof seal.

RIGID® LIMITED
LIFETIME WARRANTY

If you own a RIGID® light and it breaks, we will replace or repair it for life.*

RUGGED
CONSTRUCTION

Pro Armor lights are designed to be big and beefy with an aggressive style all their own, and housed in IP67 marine-grade rated UV polyester powdercoating.

MASSIVELY
BRIGHT

Pro Armor builds bright lights designed for any riding experience. All that power is directed through heat dissipating aluminum for streamlined heat management.

LIGHT BAR TYPES



SR-SERIES PRO

Sleek, powerful, low-profile (under 2" tall). Lights extreme distances with low energy usage.

Available in 10"



D-SERIES PRO

Compact to fit almost anywhere with high output and low energy usage.

Available in Driving, Flood & Spot



SINGLE-ROW LED

Powerful, compact, low-profile light bars with sleek look.

Available in 20"



CUBE LED

Small size allows mounting in strategic locations for added lighting.

Available in Spot

LIGHT BAR OPTIONS

SHOP & VERIFY VEHICLE FITMENT AT [POLARIS.COM/ShopSPORTSMAN](https://polaris.com/ShopSPORTSMAN)

OPTICS

DRIVING

FLOOD

SPOT

COMBO

OPTICS

3,935 ft
3,150 ft
2,360 ft
1,570 ft
785 ft

1,200 m
960 m
720 m
480 m
240 m

BRAND
SIZE
TYPE

RAW LUMENS
PN • PRICE

RIGID®
POD
D-SERIES

4,752
2883128 • \$449⁹⁹
COMES IN A PAIR

RIGID®
10"
SR-SERIES

7,920
2883122 • \$329⁹⁹

RIGID®
POD
D-SERIES

3,168
2883126 • \$229⁹⁹
COMES IN A PAIR

RIGID®
10"
SR-SERIES

7,920
2883121 • \$329⁹⁹

RIGID®
POD
D-SERIES

3,168
2883127 • \$229⁹⁹
COMES IN A PAIR

NEW
PRO ARMOR
CUBE
DUAL-ROW

1,500
2889794 • \$99⁹⁹
2889795 • \$99⁹⁹

RIGID®
10"
SR-SERIES

7,920
2883123 • \$329⁹⁹

NEW
PRO ARMOR
20"
SINGLE-ROW

4,700
2889792 • \$329⁹⁹

BRAND
SIZE
TYPE

RAW LUMENS
PN • PRICE

BUILD
YOUR
VISION

Consider the optics, angle and how you will use your vehicle to choose the right light or set of lights.

OPTICS LIGHT ANGLE	ACCENT	DRIVING (45°)	FLOOD (25°)	SPOT (10°)	COMBO (25°/10°)
DRIVING SPEED	All	Slow	Medium	Fast	Medium to fast
BEAM	Diffused glow	Extra-wide	Wide/Shorter	Concentrated/Long	Inner spot & outer flood
RECOMMENDED MOUNTING	Low/Wheel well	All points	Low &/or rear	High points	All points
TERRAIN & RIDING STYLE	Added style & personalization in any terrain	All riding & utility	Wide-open terrain or trails & utility	Trail & tight conditions	All riding & utility

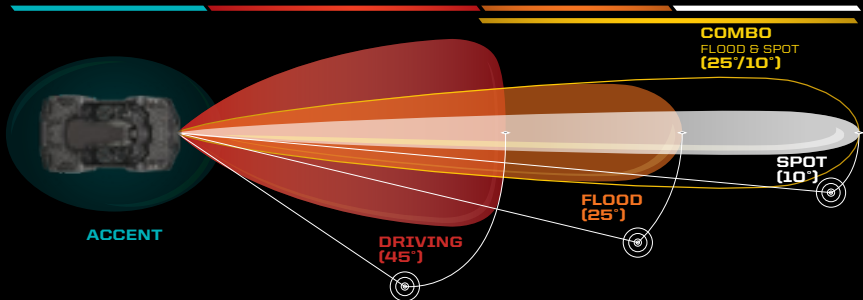

POLARIS
ENGINEERED

LED LIGHTING

LED LIGHT KIT

- Upgrade your standard headlights and pod lights to LEDs with this upgrade kit

» 2884859 • \$409⁹⁹

SPORTSMAN XP 1000 S '21-'23,
SPORTSMAN 850/1000 '21-'23,
SPORTSMAN 450/570 '21-'23
DOES NOT WORK WITH MODELS PRIOR TO '21



WIRING HARNESSES

LIGHTBAR HARNESS

- Control one light with one switch

» 2882320 • \$59⁹⁹
ALL SPORTSMAN MODELS

LED Y-HARNESS

- Requires 2882320 to control two cubes or two lights with one switch

» 2879860 • \$19⁹⁹
ALL SPORTSMAN MODELS

* If RIGID® determines, in its sole discretion, that your product is defective in material or workmanship, RIGID® will honor your warranty claim. In some cases the product will be replaced, depending on the specific time frame of the purchase. If the product is repaired, all parts, labor, and return shipping may be covered by RIGID®.

PROTECTING YOUR ESSENTIAL GEAR SINCE 1943

KOLPIN STRONGHOLD SYSTEM

Polaris is proud to partner with Kolpin Outdoors, an industry leader in off-road accessories and the premier name in gun boots and mounts. If you need to secure a firearm while riding, simply attach the auto-latch mount and choose your Gun Boot.

IDEAL FOR SECURE TRANSPORT OF SCOPED RIFLES AND SHOTGUNS

STEP 1 CHOOSE YOUR MOUNT



STRONGHOLD AUTO-LATCH MOUNT

- The auto-latching design provides quick and secure Kolpin Stronghold product attachment
- Bracket is made from rugged high impact, reinforced nylon and coated steel with precision angle adjustment for a custom fit
- For use with the Kolpin Stronghold line of products (sold separately)

» 2882272 • \$74⁹⁹
SPORTSMAN 850/1000 '17-23
DOES NOT FIT WITH ULTIMATE SERIES – BODY ARMOR (2882090)

STRONGHOLD AUTO-LATCH MOUNT

- The auto-latching design provides quick and secure Kolpin Stronghold product attachment
- Bracket is made from rugged high impact, reinforced nylon and coated steel with precision angle adjustment for a custom fit
- For use with the Kolpin Stronghold line of products (sold separately)

» 2884846 • \$74⁹⁹
SPORTSMAN 450/570 '21-23

STEP 2 CHOOSE YOUR BOOT



GUN BOOT L

- 52" L x 4¾" W x 9¼" H
- Requires Auto-Latch Mount 2882272 or 2884846 to mount to vehicle

» 2882426 • \$59⁹⁹
SPORTSMAN 850/1000 '17-23,
SPORTSMAN 450/570 '14-23



GUN BOOT XL

- Lockable and TSA Approved
- Includes padded, zippered internal protective liner
- 52" L x 3¾" W x 10½" H
- Requires Auto-Latch Mount 2882272 or 2884846 to mount to vehicle

» 2882036 • \$89⁹⁹
XP 1000 '17-23, 850 '17-23, 570 '19-23, 450 H.O. '21-23



KOLPIN RHINO GRIP

IDEAL FOR CARRYING RIFLES, SHOTGUNS,
BOWS AND CROSSBOWS.



LOCK & RIDE RHINO GRIP PRO

- » 2884119 • \$89⁹⁹
- » 2884109 • REPLACEMENT RUBBER STRAPS • \$9⁹⁹
ALL SPORTSMAN MODELS (EXCEPT UTILITY EDITIONS & YOUTH)



LOCK & RIDE RATCHETING RHINO GRIP

- » 2881157 • \$69⁹⁹
ALL SPORTSMAN MODELS (EXCEPT UTILITY AND YOUTH)



LOCK & RIDE RHINO GRIP XLR

- » 2889147 • \$44⁹⁹
- » 2889204 • RHINO GRIP XLR
REPLACEMENT RUBBER STRAPS (2) • \$9⁹⁹
ALL SPORTSMAN MODELS
(EXCEPT UTILITY EDITIONS & YOUTH)



LOCK & RIDE RHINO GRIP XLR – DOUBLES

- » 2889148 • \$69⁹⁹
- » 2889204 • RHINO GRIP XLR
REPLACEMENT RUBBER STRAPS (2) • \$9⁹⁹
ALL SPORTSMAN MODELS
(EXCEPT UTILITY EDITIONS & YOUTH)



KOLPIN GUN BOOT IV

- For 50mm scopes, rifles with slings attached, or shotguns up to 51" in length
- » BLACK • 2872677 • \$69⁹⁹



LOCK & RIDE GUN BOOT MOUNTS

- Works with Lock & Ride XL Storage Box, Lock & Ride Rear Cargo Box, and Rear Rack Extenders
- » 2878001 • \$129⁹⁹
SPORTSMAN 850/1000 TOURING '10-23
ONLY COMPATIBLE WITH KOLPIN GUN BOOT IV – NOT COMPATIBLE WITH KOLPIN STRONGHOLD GUN BOOTS

KEEP IT
ICE COLD



GRIZZLY TESTED.
POLARIS APPROVED.



This cooler is IGBC-approved, meaning it withstands the power expended by a typical grizzly bear if it was trying to get inside.

Seriously, there are experts who know what a grizzly is capable of doing, and they certify our coolers can take it.



30, 60 & 105
QUART FEATURES



ComfortCarry
Handles



TravelLock
System



EasyOut
Drain System



NoSlip
Rubber Feet



PolarWall
Insulation



IceLock
Seal

POLARIS NORTHSTAR COOLERS CAN SURVIVE JUST ABOUT ANYTHING -
FROM EXTREME HEAT TO A NASTY TUMBLE OFF A VEHICLE.



105 QUART

» GRAPHITE • 2883426 • \$419 ⁹⁹
» DESERT • 2883392 • \$419 ⁹⁹



60 QUART

» GRAPHITE • 2883425 • \$329 ⁹⁹
» DESERT • 2881259 • \$329 ⁹⁹



30 QUART

» GRAPHITE • 2883424 • \$259 ⁹⁹
» DESERT • 2881315 • \$259 ⁹⁹



15 QUART

» GRAPHITE • 2883968 • \$199 ⁹⁹



20 QUART SOFT-SIDED COOLER

» GRAPHITE • 2889285 • \$189 ⁹⁹

ESSENTIAL ACCESSORIES SO YOUR COOLER WORKS AS HARD AS YOU DO

COOLER ACCESSORIES		105 QUART	60 QUART	30 QUART	DON'T FORGET THESE ACCESSORIES	
	WIRE BASKET	2883648 • \$44 ⁹⁹	2882185 • \$30 ⁹⁹	2882438 • \$25 ⁹⁹		
	DIVIDERS Doubles as cutting board	2883468 • \$34 ⁹⁹ COMES WITH ONE DIVIDER 	2882184 • \$44 ⁹⁹ COMES WITH TWO DIVIDERS 	2882186 • \$24 ⁹⁹ COMES WITH ONE DIVIDER 		
	SEAT CUSHION	NOT AVAILABLE	2882179 • \$89 ⁹⁹	2882507 • \$69 ⁹⁹		
	WHEELS	2883967 • \$94 ⁹⁹	2882180 • \$99 ⁹⁹	NOT AVAILABLE		

HOLDS ICE
30+
HOURS
LONGER
THAN YETI®*

*YETI® is a registered trademark of YETI COOLERS, LLC

FOR THE LIFE OF YOUR RIDE

MAINTENANCE TIP

BREAK-IN PERIOD

The break-in period for your new Sportsman is the first 25 hours of operation, or the time it takes to use the first two tanks of fuel. No single action on your part is as important as a proper break-in period. Careful treatment of a new engine will result in more efficient performance and longer life for the engine.

NOTICE: Excessive heat build-up during the first three hours of operation will damage close-fitted engine parts. Do not operate at full throttle or high speeds for extended periods during the first three hours of use.

SEE OUR LATEST MAINTENANCE TIPS AT ATV.POLARIS.COM/EN-US/SELF-HELP

BATTERY

To ensure a battery maintains its level of charge when unused for extended periods of time or during freezing weather, the battery should be connected to a battery charger (see P. 57). Be sure to check for corrosion from the terminals to the ends of the cables.

BRAKE PADS

Maintaining and/or replacing brakes are critical to the safety and functionality of a vehicle. Brake pads should be checked for wear and oil or grease (petroleum products) contamination and brake discs should be checked for cracks, excessive corrosion or warping.

HALF SHAFT

Check for tears and punctures in the boot, which can lead to CV joint wear that can contribute to axle failure.

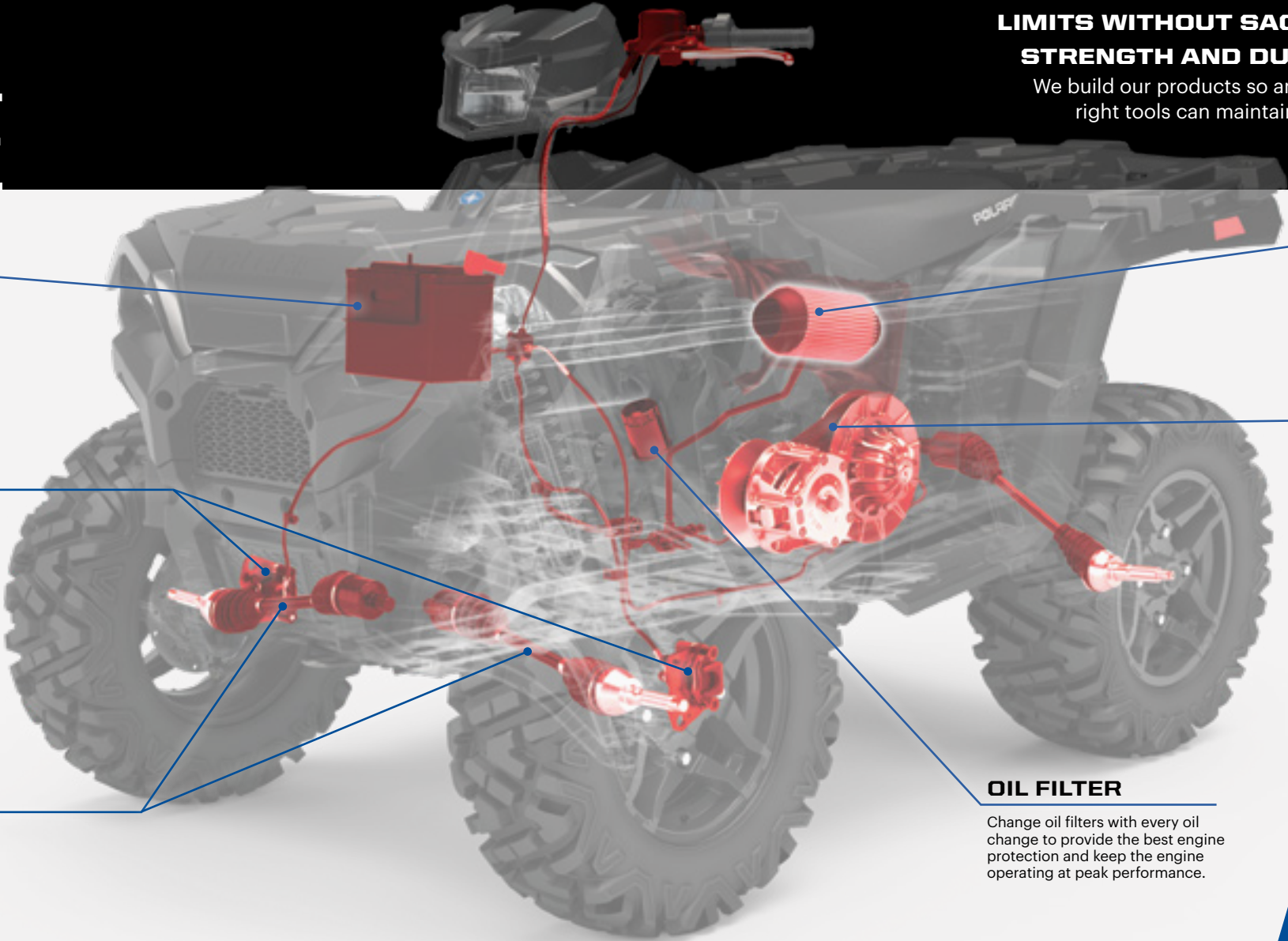

PARTS THAT PUSH THE LIMITS WITHOUT SACRIFICING STRENGTH AND DURABILITY.
We build our products so anyone with the right tools can maintain their vehicle.

POLARIS
ENGINEERED PARTS & LUBRICANTS

AIR FILTER

A clogged air filter can restrict air flow to the engine leading to reduced engine performance, engine life or catastrophic failure.

DRIVE BELT

Polaris Engineered belts deliver unmatched performance for your off-road vehicle. Developed and tested on all our engines for all environments and conditions. Check your belt for delamination, hour glassing and glazing.

BREAK-IN PERIOD

- Use lower gear (if available) while varying speeds and avoid wide open throttle for 5-10 miles / 8-16 km
- If no low gear is available, vary at moderate speeds while avoiding wide open throttle for 50 miles / 80 km

OUR INVESTMENT

- 40,000+ miles / 64,000+ km of field testing
- Thousands of dyno hours
- 18+ months of development (13,000+ design hours) per belt
- 1,500+ vehicle validation hours
- Collaboration with powertrain and clutch engineers

YOUR ADVANTAGE

- No clutch recalibration
- Less wear and tear due to heat
- Ensure maximum vehicle performance
- More time riding, less time wrenching
- Produced in collaboration with powertrain and clutch engineers to ensure a perfect fit, maximum performance and ultimate durability

OIL FILTER

Change oil filters with every oil change to provide the best engine protection and keep the engine operating at peak performance.

FOLLOW RECOMMENDED SERVICE INTERVALS IN THE OWNER'S MANUAL

MAINTENANCE SCHEDULE

25 HRS / 250 Mi / 400 km

BREAK-IN MAINTENANCE

- ENGINE OIL:** CHANGE
- GEARCASES:** CHECK OIL LEVEL
- AIR FILTER:** INSPECT & REPLACE AS NEEDED
- EXHAUST SYSTEM:** INSPECT & CLEAN
INSPECT FOR LEAKAGE OR CARBON BUILD UP AT JOINTS
INSPECT & CLEAN SCREEN TYPE SPARK ARRESTOR

50 HRS / 500 Mi / 800 km

6 MONTHS

- EXHAUST SYSTEM:** INSPECT & CLEAN
INSPECT FOR LEAKAGE OR CARBON BUILD UP AT JOINTS
INSPECT & CLEAN SCREEN TYPE SPARK ARRESTOR
- GENERAL LUBRICATION:** ALL FITTINGS, PIVOTS, CABLES, ETC.
- DRIVE BELT:** INSPECT & ADJUST
REPLACE AS NEEDED

100 HRS / 1,000 Mi / 1,600 km

12 MONTHS

- ENGINE OIL:** CHANGE
- DRIVE BELT:** INSPECT & ADJUST
REPLACE AS NEEDED
- SPARK PLUGS:** REPLACE
- EXHAUST SYSTEM:** INSPECT & CLEAN
INSPECT FOR LEAKAGE OR CARBON BUILD UP AT JOINTS
INSPECT & CLEAN SCREEN TYPE SPARK ARRESTOR

150 HRS / 1,500 Mi / 2,400 km

18 MONTHS

- BATTERY:** TEST, CLEAN & CHECK FLUID LEVEL
IF NECESSARY, REPLACE AS NEEDED
- DRIVE BELT:** INSPECT & ADJUST
REPLACE AS NEEDED
- TIRES:** INSPECT CONDITION & PRESSURE
- EXHAUST SYSTEM:** INSPECT & CLEAN
INSPECT FOR LEAKAGE OR CARBON BUILD UP AT JOINTS
INSPECT & CLEAN SCREEN TYPE SPARK ARRESTOR

200 HRS / 2,000 Mi / 3,200 km

24 MONTHS

- ENGINE OIL:** CHANGE
- TRANSMISSION FLUID:** CHANGE
- GEARCASES:** CHECK OIL LEVEL
- BRAKE PADS & FLUID:** INSPECT & CLEAN
REPLACE AS NEEDED
- SPARK PLUGS:** REPLACE
- EXHAUST SYSTEM:** INSPECT & CLEAN
INSPECT FOR LEAKAGE OR CARBON BUILD UP AT JOINTS
INSPECT & CLEAN SCREEN TYPE SPARK ARRESTOR

250 HRS / 2,500 Mi / 4,023 km

30 MONTHS

- ENGINE OIL:** CHANGE
- BATTERY:** TEST, CLEAN & CHECK FLUID LEVEL
REPLACE AS NEEDED
- DRIVE BELT:** INSPECT & ADJUST
REPLACE AS NEEDED
- GENERAL LUBRICATION:** ALL FITTINGS, PIVOTS, CABLES, ETC.
- EXHAUST SYSTEM:** INSPECT & CLEAN
INSPECT FOR LEAKAGE OR CARBON BUILD UP AT JOINTS
INSPECT & CLEAN SCREEN TYPE SPARK ARRESTOR

300 HRS / 3,000 Mi / 4,828 km

36 MONTHS

- ENGINE OIL:** CHANGE
- AIR FILTER:** INSPECT & REPLACE AS NEEDED
- GEARCASES:** CHECK OIL LEVEL
- SPARK PLUGS:** REPLACE
- EXHAUST SYSTEM:** INSPECT & CLEAN
INSPECT FOR LEAKAGE OR CARBON BUILD UP AT JOINTS
INSPECT & CLEAN SCREEN TYPE SPARK ARRESTOR

CHECK YOUR OWNER'S MANUAL FOR ADDITIONAL RECOMMENDED SERVICE ITEMS AND VEHICLE-SPECIFIC TIMING

PARTS & GARAGE

MAINTENANCE

OIL & LUBRICANTS

MAINTENANCE FLUIDS

GARAGE ACCESSORIES & BATTERY CHARGERS

HD PARTS

SERVICE PARTS

TIRE SEALANT & TRAILERING

POLARIS POWER

OIL



PS-4 FORMULATIONS BEST PROTECTION, BEST PERFORMANCE

Our new PS-4 5W-50 formulation and PS-4 Extreme Synthetic 0W-50 have been designed to provide the best fluid technologies for long lasting wear protection. These formulations include a new Polaris exclusive additive system to keep the engine cleaner from deposit build-up to maximize power and powersports-grade synthetic base stocks that provide the ultimate in engine protection.

PS-4 5W-50 FULL-SYNTHETIC OIL

Optimal for ambient operating temperatures of -40° F to 100° F

» 1 Quart	» 1 Gallon	» 16 Gallons	» 55 Gallon Drum	» 330 Gallon Tote
2876244	2876245	2876247	2876246	2878814

PS-4 0W-50 **EXTREME** FULL-SYNTHETIC OIL

Optimal for ambient operating temperatures of -45° F to 130° F

» 1 Quart	» 1 Gallon	» 16 Gallons	» 55 Gallon Drum	» 330 Gallon Tote
2889395	2889396	2889397	2889398	2889399

OIL CHANGE KITS		
These convenient kits include everything needed including filter and oil volume per vehicle		
PART NUMBER	VEHICLE FITMENT	PART NUMBER
2202166	RANGER/RZR/SPORTSMAN 570, TWIN 600, TWIN 700, TWIN 800	2890056
2879323	RANGER, POLARIS GENERAL 900-1000, RZR 900-1000, RS1	2890057
2877473	RANGER/SPORTSMAN 300-500, SPORTSMAN/SCRAMBLER 500/850/1000	2890055
2881696	RZR TURBO	2890058

ENGINE WEAR TEST LOWER NUMBER = LESS WEAR OF CRITICAL ENGINE PARTS LESS WEAR MEANS LONGER ENGINE LIFE

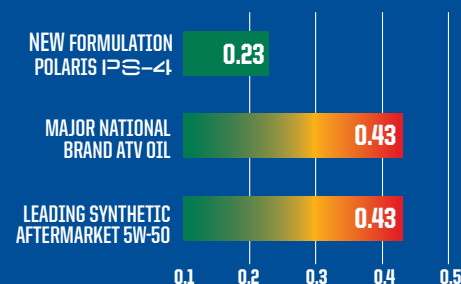

ASTM D4172. In 3rd party against 11 competitive products Polaris had 40% or better wear protection compared to all of the test products.

THE BEST PROTECTION

- At least 40% improved wear protection compared to previous Polaris PS-4 formulation and all aftermarket oils tested

Best engine protection against wear for the longest engine life.

DEPOSIT TEST LOWER DEPOSITS = MAXIMUM POWER

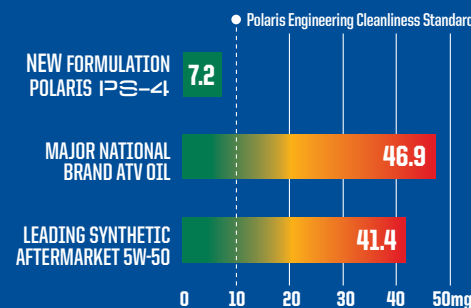

ASTM D6395. In 3rd party against 9 competitive products Polaris PS-4 had less than half the deposits compared to the next closest product. No other tested products met Polaris Engineering standards for deposit cleanliness.

MAXIMUM PERFORMANCE

- New improved PS-4 formulation provides 33% less deposits than previous PS-4 formula
- At least 50% less deposits than all aftermarket oils tested

The cleanest engine for maximum power and performance!

POLARIS **EXTREME** SYNTHETICS

Our new PS-4 Extreme Synthetic 0W-50 formulation applies only to the **absolute highest performance** products we sell, for ultimate protection and performance in the most extreme conditions.



- Our best extreme high temp formulation, excellent for severe high temperatures and for racing, even at temps over 130°F.
- Provides easier starting and cold temperature protection, even to extreme cold temps of below -45°F.
- Latest in premium synthetic PAO and Ester base stocks along with careful balance of moly and ZDDP additives for ultimate long lasting wear protection.

- Polaris exclusive clean engine additive system reduces deposits and carbon build-up for peak performance and power.



POLARIS INVESTS IN EACH OIL
AT AND ABOVE THESE LEVELS

12+ DEDICATED
TEAM MEMBERS

FOCUSED ON
POLARIS OIL

18+
MONTHS

DEVELOPMENT
& TESTING

76,000+
HOURS

DYNO
TESTING

2.2/3.5 MILLION+
MILES/KM

FIELD
TESTING

MAINTENANCE FLUIDS



DOT 4 BRAKE FLUID

A high-quality brake fluid designed for use in Polaris hydraulic brakes.

Change every 200 hours, 24 months, or 2,000 miles / 3,200 km.

» 12 OZ • 2872189



AGL

Protect gears, drive chain and bearings from scoring and wear.

Change every 200 hours, 24 months or 2,000 miles / 3,218 km.

» 1 QT • 2878068
» 1 GALLON • 2878069
» 2.5 GALLONS • 2878070
» 55 GALLONS • 2879594



ORV MAINTENANCE KIT

Everything you need, in the correct fluid volumes, to maintain your drive train and keep your vehicle in top operating condition

- NEW**
- Includes: 1 Spark Plug, 1 Air Filter, 2 quarts PS-4, 1 Oil Filter, 1 pint Demand Drive Fluid, 1 quart AGL, 1 Crush Washer, 1 Paper Funnel

» 2830549
570 *14-23, 450 *16-23



ANTI-FREEZE

Prevent corrosion on metal components, eliminate scaling and maximize cooling system performance.

Change every 60 months.

» 1 QT • 2880514
» 1 GALLON • 2880513
» 55 GALLONS • 2880512



DEMAND DRIVE FLUID

Provide positive 4WD engagement in extreme cold or high heat conditions and protect internal components under heavy loads.

Change every 100 hours or every 36 months.

» 1 QT • 2877922
» 2.5 GALLONS • 2877923

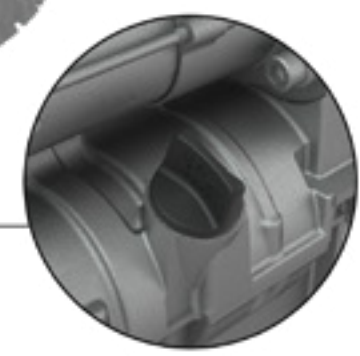

ENGINE OIL

Maximum protection for your 4-cycle engine.

Change every 100 hours, 1,000 miles / 1,600 km or 12 months.



PREMIUM GAS SHOCK OIL

» 1 QT • 2874124
WALKER EVANS RACING® REBUILDABLE SHOCKS

» 1 QT PREMIUM • 2870995
» 2.5 GALLONS PREMIUM • 2872279
FOX® REBUILDABLE SHOCKS



SUSPENSION/ U-JOINT GREASE

» 3 OZ • 2871515
» 14 OZ • 2871551



CHAIN LUBRICANT

- Provides superior anti-wear and shock protection

» 16 OZ AEROSOL 2872348



ALL-SEASON GREASE TUBE

- Specialized water-resistant lubricant

» 3 OZ • 2871322
» 14 OZ • 2871423



ANGLE DRIVE FLUID

- Extreme pressure, anti-wear and high viscosity film lubrication for maximum protection

» 1 QT • 2889280



GENERATOR OIL

- 4-cycle engine oil

» 1 QT • 2879383



CARBON CLEAN

- Ultimate fuel and injection system cleaner

» 12 OZ • 2881413



ADVANCED FUEL TREATMENT

- Dual antioxidant formula protects jets and fuel system from gum and varnish

» 12 OZ • 2881416

GARAGE ACCESSORIES



PREMIUM MAINTENANCE TOOL KIT

- Includes everything you need to work on and repair Polaris vehicles
 - Lifetime warranty on select tools
- » 2830565 • \$499⁹⁹



FLUID FUNNEL

- Easily add oil with high accuracy
- » 2830552 • \$12⁹⁹



FUNNELS

- Unique capped design eliminates spills and contaminants
- » BLUE • 2830574 • \$8⁹⁹
» RED • 2830575 • \$8⁹⁹
» GREEN • 2830576 • \$8⁹⁹



HANDHELD PUMP SPRAYER

- Half gallon portable sprayer, lightweight and easy to use
- » 2830570 • \$12⁹⁹

BATTERY CHARGERS



GREASE GUN

- Comfort grip handle and heavy-duty follower spring for high pressure applications and easy priming
- » 14 OZ • 2830569 • \$34⁹⁹
FOR 14 OZ ALL-SEASON & U-JOINT



GREASE GUN

- Enables easy application of grease
- » 3 OZ • 2871312 • \$39⁹⁹
FOR 3 OZ ALL-SEASON & U-JOINT



FLEX SPOUT

- Fits all Polaris quart, gallon and 2.5 gallon bottles
- » 2871285 • \$3⁹⁹



PUMP

- Fits 1 and 2.5 gallon bottles
- » 2870465 • \$7⁹⁹



FLUID SYRINGE

- Easily add and remove fluid from your vehicle
- » 2830553 • \$29⁹⁹



2D BATTERY-OPERATED SIPHON PUMP

- Liquid transfer pumps 5–6 quarts/min suctioning power
- » 2830513 • \$16⁹⁹



FLEXIBLE CLUTCH COVER TOOL

- The perfect tool for hard to reach CVT cover bolts
- » 2830572 • \$14⁹⁹



OIL FILTER WRENCH

- Remove Polaris ORV oil filters with ease
- » 2830550 • \$7⁹⁹



FLUID TRAY

- Holds up to 8 quarts of fluid
- » 2830551 • \$19⁹⁹



POLARIS MAGNETIC PARTS TRAY

- » SILVER • 2830432 • \$12⁹⁹



POLARIS 33" TELESCOPIC MAGNET

- » BLACK • 2830435 • \$4⁹⁹



POLARIS 12" HI-TORQUE RATCHETING DRIVER

- » BLACK / BLUE • 2830434 • \$19⁹⁹



POLARIS LED POCKET FLASHLIGHT

- » BLACK • 2830436 • \$24⁹⁹



NOCO® BATTERY CHARGER - 1 AMP

- Ensure your battery is charged with the NOCO® Battery Charger 1 Amp
 - Includes Boost Eyelet Cable with X-Connector Adapter (2830546)
- » 2830567 • \$64⁹⁹



NOCO® BATTERY CHARGER - 2 AMP

- Ensure your battery is charged with the NOCO® Battery Charger 2 Amp
 - Includes Boost Eyelet Cable with X-Connector Adapter (2830546)
- » 2830568 • \$99⁹⁹



1,000 AMP ULTRASAFE LITHIUM JUMP PACK

- Delivers 1,000 amps for jump starting a dead battery in seconds
- » 2830547 • \$124⁹⁹



JUMP PACK PROTECTION CASE

- Lightweight, durable and rugged custom exterior
- » 2830548 • \$18⁹⁹

HD

HEAVY DUTY PARTS

All Polaris parts are developed and tested to help you get the most out of your ride. We're taking the passion of our riders, workers and outdoor enthusiasts to the next level with HD Parts.

Engineered and designed for:

- Greater durability
- Enhanced performance
- Greater wear and tear capabilities
- All weather conditions

OIL FILTERS

The advanced synthetic material built into these filters offers the highest debris holding capacity, maintains oil flow and maximizes performance.

OE	HD
2520799	2522485
2540086	2522498

WHEEL BEARINGS

Fully sealed for added protection against intrusions. Made of a higher grade steel for extended life in extreme conditions.

LOCATION	OE	HD
FRONT WHEEL BEARINGS	3514822	3515090
	3514634	3515088
REAR WHEEL BEARINGS	3514917	3515087

WHEELS & TIRES

Class leading durability for off-road performance and traction for confident driving in extreme conditions.

- » 1524022-458 • HD WHEEL - 14x7
- » 5457498-458 • HD WHEEL CENTER CAP
- » 5415756 • PRO ARMOR XD-K FRONT
- » 5415757 • PRO ARMOR XD-K REAR

DRIVE BELTS

The enhanced rubber material compound in these belts keep them cool in extreme heat, while our patented cord treatment process maximizes the transfer of horsepower to the ground for those customers hauling heavy loads.

OE	HD
3211149	3212326
3211077	3212328
3211113	3212332
3211160	3212331

BUSHINGS

The advanced material compound of the bushings enables tighter tolerances to reduce overall wear on the system, while the superior triple lip sealing prevents intrusion of the elements.

LOCATION	OE	HD
FRONT UPPER BUSHINGS	5439874	1543367
FRONT LOWER BUSHINGS	5439874	1543367
	5436973	1543326
REAR UPPER BUSHINGS	5439874	1543367
	5438895	1543326
REAR LOWER BUSHINGS	5439874	1543367
	5436973	1543326

NEW CV BOOT KIT

TPE rubber compound for maximum puncture and tear resistance, includes (1) boot, grease and clamp to replace OE stock part. Provides increased durability for riding in extreme conditions.

OE	HD
2204102	2209922
3236165	2209923

BRAKE PADS

Engineered to provide longer life and better stopping power while riding in extreme conditions.

LOCATION	OE	HD
FRONT	2205949	2208933
FRONT/REAR	2202413	2208934
	2202412	2208935

BUSHING KITS

Easily update the entire front and rear suspension.

- » 2830562 (SHOWN)
570 EFI '16-'20, 570 EFI X2 '16-'20,
570 EFI TOURING '16-'20,
570 EPS UTILITY '20,
450 HO '16-'20, 450 UTILITY '20
- » 2830563
570 SP '16-'19, 570 PREMIUM '19,
570 SP TOURING '16-'20

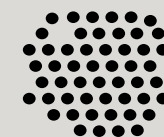

SAND



MUD



WATER



EXTREME COLD



EXTREME HEAT
UP TO 130° F



HEAVY PAYLOADS



EXTENDED LIFE

PARTS & GARAGE

MAINTENANCE

OIL & LUBRICANTS

MAINTENANCE
FLUIDS

GARAGE ACCESSORIES
& BATTERY CHARGERS

HD PARTS

SERVICE PARTS

TIRE SEALANT
& TRAILERING

POLARIS POWER

VISIT [POLARIS.COM/HD PARTS](https://www.polaris.com/hdparts)
TO LEARN MORE

Claims made based off testing and performance of Polaris HD Parts against standard OEM parts made by Polaris and competitor brands under normal use.

For more information regarding Polaris HD parts including vehicle compatibility, installation and maintenance, please contact your authorized Polaris ORV dealer.

SERVICE PARTS

Polaris Engineered service parts deliver unmatched performance and fit for your off-road vehicle.

All service parts are engineered specifically for your machine. Which means everything is designed, tested and perfected to maximize the life of your ride. Getting Polaris Engineered parts is a decision that pays off in the long run, because it ensures there is a long run.



**SHOP FOR SERVICE PARTS ONLINE
OR VISIT YOUR POLARIS DEALER.**

CHECK OUT OUR PARTS FINDER ON POLARIS.COM
FOR EASY PARTS LOOK-UP, PARTS IDENTIFICATION, VIEWS OF ASSEMBLIES & MORE!

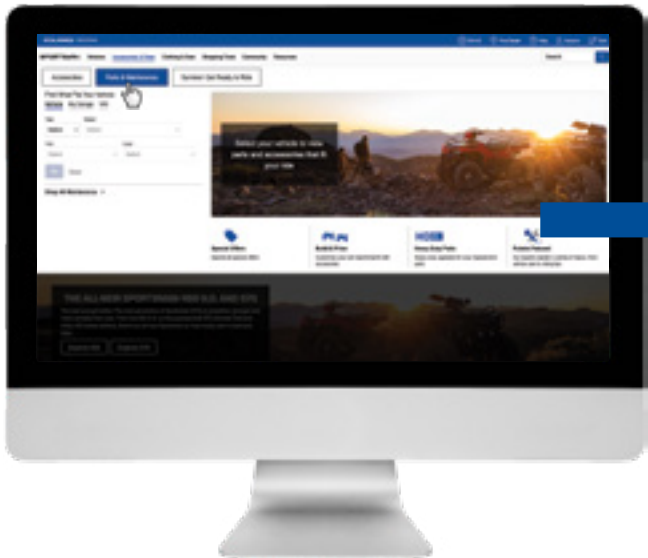

STEP 1

Visit **Polaris.com/Sportsman**
Click the “**Accessories & Parts**” tab
Click “**Parts & Maintenance**”

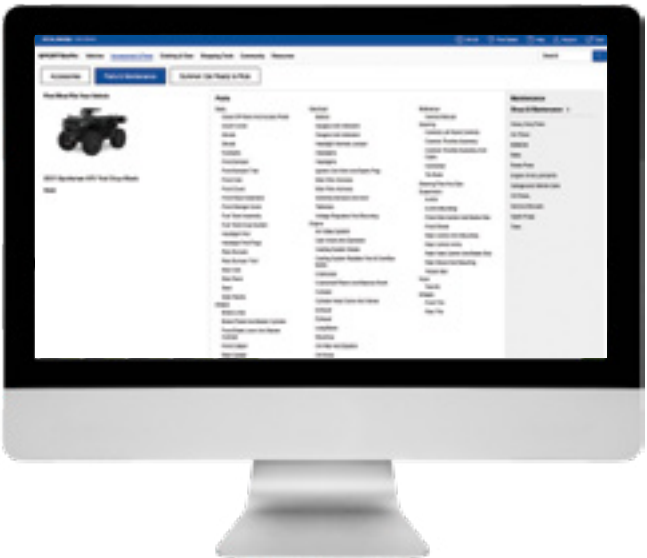

STEP 2

Enter **vehicle year/model** or
shop by **part number**



STEP 3

Clearly see what parts are
required and **order**

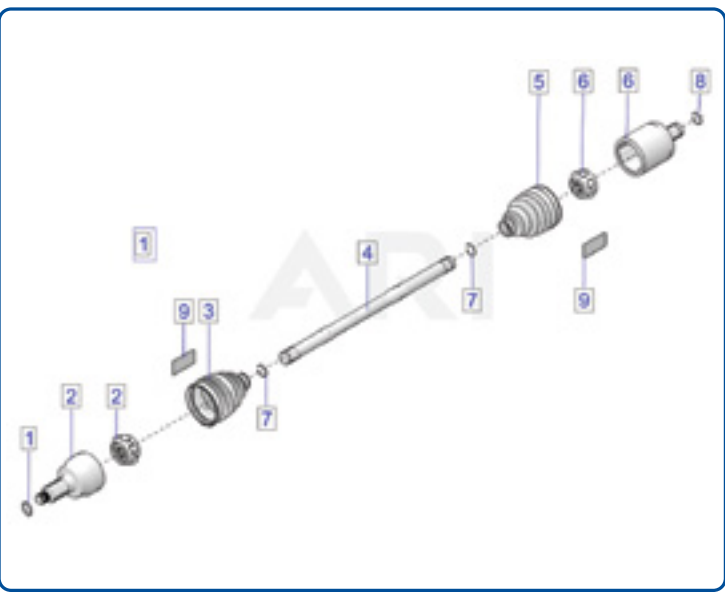

OVER
100,000 PARTS
AVAILABLE!

CV BOOT REPAIR KIT*

- A quick trail-side fix to increase trail time
- The flexible and durable boot material expands over a cone tool for CV boot repairs, without disassembling CV axles
- Universal fit – works as a temporary fix for most powersports axles
- All components fit inside the cone, and a cover is provided for compact durable storage
- Easily fits in a cargo box, attached to the roll cage, in the glovebox or many other storage locations



Items shown are contained inside cone

ATV CV BOOT REPAIR KIT

Kit includes the following items:

- (1) Expandable CV Boot
- (1) Reusable Cone Tool
- (2) CV Boot Clamps
- (1) Tube of Silicone Lube
- (1) Grease Packet
- (1) Cone Cover

» 2830528 • \$25⁹⁹

ATV TRAIL BOOT ONLY

» 2830529 • \$14⁹⁹

UTV

» CV REPAIR KIT
2830526 • \$29⁹⁹
» TRAIL BOOT ONLY
2830527 • \$14⁹⁹

SEE HOW THE CV BOOT REPAIR KIT WORKS
AT [POLARIS.COM/MAINTENANCE-VIDEOS](https://www.polaris.com/maintenance-videos)



HOW TO INSTALL

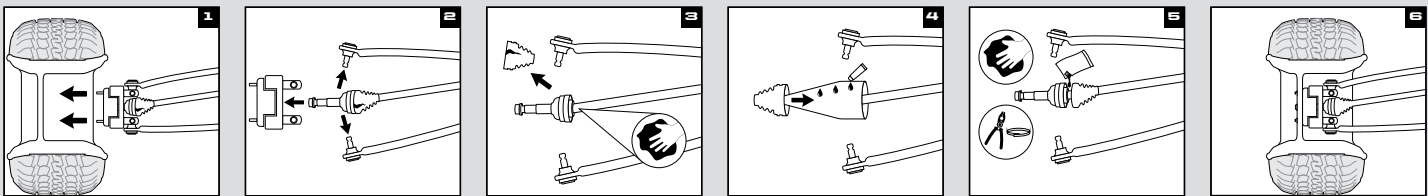

Remove wheel and axle nut. Remove brake caliper, hub, tie rod and upper and lower ball joints. Remove old boot and clean joint. Spread silicone lube on entire cone tool. Slide boot over cone tool, large end first. See package for outer boot instructions. Empty the bag of grease into the CV joint/boot, clean sealing points and install clamps. Reassemble tie rod, ball joints, brake caliper, axle nut, tire and wheel.

Refer to your service manual for further instructions and torque specifications.
*Designed for temporary CV boot repair. Purchase the OEM CV Boot for a permanent repair.

TIRE SEALANT

HOW IT WORKS

Tire sealant remains liquefied inside the tire until a leak develops in the tire or wheel.



Once a leak occurs, the tire sealant rushes out of the tire and quickly creates a permanent solid plug.

The plug maintains the pressure of the tire so you can continue your ride.



HOW MUCH TIRE SEALANT DO YOU NEED?

$$\begin{array}{ccccc} \text{TIRE} & & & & \\ \text{HEIGHT} & \times & \text{TIRE} & / & \text{OUNCES} \\ \text{(IN.)} & & \text{WIDTH} & & \text{REQUIRED} \\ & & \text{(IN.)} & & \text{PER TIRE} \\ & & | & & | \\ 27" & \times & 10" & / & 5 = 54 \text{ oz} \end{array}$$

FOR A FULL APPLICATION CHART, VISIT
[POLARIS.COM/TIRESEALANTCHART](https://www.polaris.com/tiresealantchart)

PREMIUM TIRE SEALANT

- Instantly seals and repairs rim, bead leaks and punctures up to .25" on standard tires and .75" on heavy ply tires
- Helps maintain air pressure for the life of the tire
- Helps seal the tire bead against the wheel
- 100% water soluble for easy cleanup
- Will not rust, corrode or pit wheels
- Creates permanent repair
- Remains fluid and effective in temperatures down to -45° F
- Easily installed through existing tire valve stem with valve core removed

» 32 OZ • 2830484 • \$20⁹⁹

» 1 GALLON • 2830485 • \$72⁹⁹

» 5 GALLONS • 2830486 • \$298⁹⁹

» 5 GALLONS PUMP • 2830487 • \$133⁹⁹

» 55 GALLONS • 2830489

» 275 GALLONS • 2830488

FIX ON THE GO | TEMPORARY COVERAGE

TRAILERING

CALIBER® RAMP PRO

- Designed for ATVs and UTVs up to 50" wide
 - Integrated grip glides for ultimate traction
 - Folding sides for easy transportation and storing
- » 52" x 90" • 2884576 • \$694⁹⁵

ALUMINUM ARCHED LOADING RAMPS

- Capacity for up to 3,000 lb
- » 76" x 12" • 2,000 lb • 2875384 • \$359⁹⁹
» 88" x 12" • 3,000 lb • 2875386 • \$649⁹⁹

LIGHTWEIGHT TRI-FOLD RAMPS

- Ramp folds up for transport
 - Capacity for up to 1,500 lbs
 - Safety straps included
- » 72" x 51" • 2875385 • \$349⁹⁹
» 82" x 51" • 2875860 • \$399⁹⁹

FOLDING ALUMINUM ARCHED RAMPS

- Ramp folds up for transport
 - Up to 1,500 lb total capacity, 750 lb per individual ramp
 - Safety straps included
- » 88" x 12" • 2875387 • \$454⁹⁹

HITCHES

3:1 HITCHES VERSATILE 3 IN 1 FUNCTIONALITY

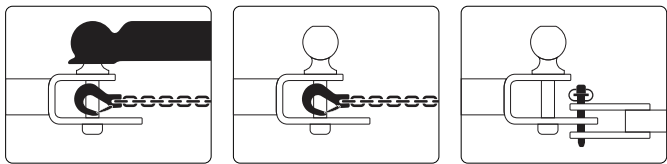

BALL

HOOK

PIN

- Ball, hook and pin design
- Durable, rust resistant steel with black powdercoated finish

- Removable ball
- HD 5/8" pin and clip



HITCH WITH 2" BALL

» 2" x 2" RECEIVER
2830522 • \$39⁹⁹

» 1 1/4" x 1 1/4" RECEIVER
2830523 • \$39⁹⁹



1 7/8" BALL

- 1 1/4" replacement ball for hitch
 - Designed to work with 3:1 Hitch
- » 2830524 • \$9⁹⁹



RECEIVER HITCH

» 2" RECEIVER TONGUE
2875320 • \$44⁹⁹



TRAILER BALL AND SHANK

» 1 7/8" BALL • 2877602 • \$14⁹⁹
» 2" BALL • 2877603 • \$14⁹⁹

COVERS

TRAILERABLE COVER

» 2876614 • \$184⁹⁹

SPORTSMAN 450/570,
SPORTSMAN 850/1000
REPLACEMENT STRAP 2871912

» 2877999 • \$184⁹⁹

ALL SPORTSMAN TOURING
REPLACEMENT STRAP 2871912



STRAPS & ROPES



RECOVERY STRAP

- 2" x 30'
 - 18,000 lb maximum load, 9,000 lb maximum vehicle weight
 - Comes with carry bag
- » 2884033 • \$59⁹⁹



RATCHET STRAP

- 1.5" x 15' straps, 2 Pack
 - Heavy duty webbing
 - 5,500 lb maximum load, 1,833 lb working load
- » 2884031 • \$44⁹⁹



RATCHET STRAP

- 2" x 20' Ratchet Straps
 - Heavy duty webbing, floating D-rings, double J-hooks
 - 10,000 lb maximum load, 3,300 lb working load
- » 2884032 • \$34⁹⁹



SHOCK STRAPS

- 1.5" 3,000 lb breaking strength
 - Keeps tension on tie-down straps to secure load, 2 Pack
- » 1.5" x 15' • 2883296 • \$84⁹⁹
» 1.5" x 7' • 2883295 • \$74⁹⁹

POLARIS
POWER

FOR THE WORKERS, PLAYERS
AND SAVE-THE-DAYERS.

BACKED BY A



WARRANTY



THE POWER TO EMPOWER

At Polaris Power, we are committed to powering more.
We proudly donate 3% of our profits by providing
portable power to areas affected by natural disasters
and the organizations providing relief in North America.



VISIT [POLARISPOWER.COM](https://polarispower.com)
FOR ALL PRODUCT FEATURES



P2000i

Inverter Generator

2830532

\$799⁹⁹

1600

Running
Watts

2000

Starting
Watts

16.7

Max Amps
at 120V

7.6

Run Time at 25%
Load w/ Smart
Throttle (hrs)

62

Noise Level
at 25% Load
(dBA)

FEATURES



Extension Cord
Management



Multi Functional
Digital Display



Illuminated
Control Panel



Multi Handle Design



Parallel Capable

BEST USED FOR



Tailgating



Off-Grid



Camping



ACCESSORIES

2830536
2830541

INVERTER PARALLEL KIT
ALL WEATHER COVER

2884866
2879383

HIGH ALTITUDE MODIFICATION KIT
GENERATOR OIL

Read, understand and follow your owner's manual. Never operate a generator indoors. Generator exhaust contains carbon monoxide vapors and exposure can result in severe injury or death. Gasoline is highly flammable and explosive under certain conditions. Always use extreme care whenever handling gasoline.

PARTS & GARAGE

MAINTENANCE

OIL & LUBRICANTS

MAINTENANCE
FLUIDS

GARAGE ACCESSORIES
& BATTERY CHARGERS

HD PARTS

SERVICE PARTS

TIRE SEALANT
& TRAILERING

POLARIS POWER



P5500 / P6500

2830534 / 2830535
Open Frame Generator \$1,499⁹⁹ / \$1,699⁹⁹

FEATURES



Extension Cord Management



Fuel Gauge



Electric Start



Rough Terrain Wheel

BEST USED FOR



Construction



Home Backup



RV'ing

5000 / 6000	5500 / 6500	20/30	5	75
Running Watts (P5500 / P6500)	Starting Watts (P5500 / P6500)	Max Amps at 120/240V	Run Time (hrs)	Noise Level (dBA)



ACCESSORIES

2830542 2884867
ALL WEATHER COVER
HIGH ALTITUDE MODIFICATION KIT

2879383 GENERATOR OIL



NEW
PRESSURE WASHER 3700

- 3700 PSI at 2.5 GPM
- Simpson Pro-Axial Cam Pump
- CRX 4-stroke 225cc OHV engine
- Low-oil shut-down system
- 10" pneumatic tires
- Heavy-duty steel engine plate
- 1.25" tubular construction
- Professional spray gun
- 50' Morflex® hose

» 2830573 • \$849⁹⁹

PRESSURE WASHER ACCESSORIES



NEW
EXTENSION HOSE

- Designed to be highly flexible and kink resistant
- This cold water hose is equipped with standard M22 threaded connections, a dual o-ring and polyurethane outer jacket that is non-marring and abrasion-resistant for improved durability

» 2830577 • \$79⁹⁹



NEW
TURBO NOZZLE

- 3700 PSI .25" QC turbo nozzle delivers a strong jet of oscillating water that cleans faster than standard nozzles
- Made for reliability and durability, this nozzle is easy to use and great at cleaning hard to remove dirt and debris

» 2830579 • \$54⁹⁹

Read, understand and follow your owner's manual. Never operate a generator indoors. Generator exhaust contains carbon monoxide vapors and exposure can result in severe injury or death. Gasoline is highly flammable and explosive under certain conditions. Always use extreme care whenever handling gasoline.



APPAREL

GEAR UP FOR YOUR ADVENTURE. Adventure invites you to gear up and make the most out of every moment, through the thrills, the fun and the memories. Live boldly on and off the trail with Polaris apparel and represent the brand that helps you get outside, stay outside, and THINK OUTSIDE.

APPAREL

JERSEYS & GLOVES
& HEATED APPAREL

HELMETS & GOGGLES

MEN'S APPAREL

BALL CAPS

CAMO APPAREL

WOMEN'S APPAREL

HOME
& COLLECTIBLES

JERSEYS & GLOVES



OFF-ROAD RIDING JERSEYS

\$34⁹⁹ / \$29⁹⁹ (adult/youth)

Mesh ventilated panels for maximum airflow
Elastic sleeves with non-restrictive cuffs



BLACK
JERSEY | S-3XL | 2862718
GLOVES | S-3XL | 2862726
YOUTH JERSEY | S-XL | 2862723



ORANGE
JERSEY | S-3XL | 2862719
GLOVES | S-3XL | 2862729



TEAL
JERSEY | S-3XL | 2862720
GLOVES | S-3XL | 2862727
YOUTH JERSEY | S-XL | 2862724



GREEN
JERSEY | S-3XL | 2862721
GLOVES | S-3XL | 2862730



BLUE
JERSEY | S-3XL | 2862722
GLOVES | S-3XL | 2862728
YOUTH JERSEY | S-XL | 2862725

OFF-ROAD RIDING GLOVES

\$24⁹⁹

Adjustable wrist closure for a custom fit
Silicon finger grips and neoprene knuckle protection



TEKVEST[®]
FREESTYLE

\$349⁹⁹
Black | S-3XL | 2862577

HEATED APPAREL

Keep warm even on the coldest days with Polaris Heated Apparel. By keeping the heat close to your body, you can stay out for a longer, more comfortable ride. The Polaris Heated Apparel lineup includes the Heated Vest, Heated Base Layers and a Heated Glove Liner for both men and women. Easily control your heat setting with the touch of a button.



WOMEN'S | \$199⁹⁹
Black | S-3XL | 2833036

MEN'S | \$199⁹⁹
Black | S-3XL | 2833022



\$139⁹⁹
Black | S-3XL | 2833044

NEW
HEATED VESTS

WARMTH WITH THE TOUCH OF A BUTTON

- Perfect for any outdoor activity
- Down-proof machine washable material with 160g of insulation for warmth with or without the heater turned on
- Powered by a small rechargeable battery (included) that can also be used to charge a cellphone; battery not machine washable, remove prior to washing
- Easily adjust between four heat settings for changing weather conditions with built-in buttons

NEW
HEATED GLOVE LINER

KEEP YOUR HANDS WARM ON FROSTY DAYS

- Designed to fit under all Polaris riding gloves for an extra layer of warmth to keep you out riding longer
- Easily adjust your heat level by pressing a button on the bottom part of the glove



WOMEN'S | \$129⁹⁹
Top | S-3XL | 2833033
Bottom | S-3XL | 2833034

MEN'S | \$129⁹⁹
Top | S-3XL | 2833031
Bottom | S-3XL | 2833032

NEW
HEATED BASE LAYERS

ADJUSTABLE HEAT CLOSE TO YOUR BODY, MAXIMUM COMFORT IN CHANGING CONDITIONS

- Intended for use as a base layer
- Features lightweight, moisture-wicking fabric to give you the most comfortable layering to wear on all of your cold weather adventures, on or off the trail
- Includes multiple heat panels for evenly distributed heat for maximum warmth and comfort
- Powered by a small rechargeable battery (included) that can be used to charge a cellphone; battery not machine washable, remove prior to washing
- Easily adjust between four heat settings for changing weather conditions with built-in buttons

FOR
POLARIS

NEW
RED
XS-4XL
2833054



ALTITUDE

509 ALTITUDE 2.0 HELMET

LIGHTWEIGHT DESIGN, PERFORMANCE-INFUSED
STYLE AND GOPRO® MOUNTING CAPABILITY

SHELL

- Thermoplastic poly alloy outer shell

\$329 95

WEIGHT

- Composite as low as 1,200g
- Carbon fiber as low as 1,150g

FEATURES

- Strong, lightweight construction of carbon fiber or composite
- Superior fit for all-day comfort
- Pro Series breath box for complete protection, removable for optimal air flow
- One-piece eyeport creates draft-free seal with 509 goggles
- Magnetic Fidlock® chin-strap technology and integrated GOPRO® mount
- DOT- and ECE 22.05-approved

FIDLOCK®



NEW
RADIANT GREEN
XS-4XL
2833051



BLACK
XS-4XL
2861469



\$429 95
CARBON FIBER
BLACK/LIME
XS-4XL
2861473

FOR
POLARIS

NEW
PINK
XS-4XL
2833050



TACTICAL

TACTICAL 2.0 HELMET

COMBINES STYLE WITH VERSATILITY
FOR ULTIMATE COMFORT AND CONTROL

SHELL

- Shock-resistant, injection-molded thermoplastic

\$229 95

FEATURES

- Innovative Venturi Vent pulls moist air from helmet without cold wind coming in
- Eyeport seal is co-integrated with the removable breath box and creates a draft-free seal with 509 goggles and a clear field of view
- Magnetic Fidlock® chin-strap technology
- DOT- and ECE 22.06-approved

FIDLOCK®



MATTE BLACK
XS-4XL
2862468



GRAY
XS-4XL
2862469



RED/BLACK
XS-4XL
2862467



ORANGE
XS-4XL
2862471

GOGGLES



ORANGE
2862561



LIME
2862559

509 KINGPIN OFF-ROAD GOGGLE

PREMIUM MATERIALS, ATTRACTIVE PRICE

\$49 95

FEATURES

- Oversized spherical lens delivers optimal peripheral vision
- Metal tear-off posts provide strength and durability
- Quick-change technology allows you to run the best lens tint for conditions



BLUE
2862562



STEALTH
2862560

509 MX6 OFF-ROAD GOGGLE

SUPER WIDE FIELD OF VIEW, ENGINEERED FOR DIRT

\$99 95

FEATURES

- PC outer lens with anti-scratch coating, and internal anti-fog coating
- Outriggers with latch system for quick lens change
- 45mm strap with silicone to hold strap in place



BLACK
2862557



RED/BLACK
2862558



RED/GRAY
S-3XL | 2833029

BLACK
S-3XL | 2861432

FORCE PUFFER JACKET

PACKABLE JACKET OFFERS LIGHTWEIGHT PROTECTION, IDEAL FOR ANY ACTIVITY

- 140g 3M® Thinsulate®
- Plenty of storage with two external hand pockets and one internal media pocket
- Rugged YKK® zippers
- Great for travel, compacts into pocket

\$139 99



ORANGE
S-3XL | 2833027

BLUE
S-3XL | 2833028

BLACK
S-3XL | 2861434

SOFTSHELL JACKET

VERSATILE LIGHTWEIGHT JACKET THAT'S PERFECT FOR EVERYDAY WEAR

- Casual jacket armed with rugged and warm features for everyday wear
- Superior DWR prevents precipitation from saturating the jacket's exterior
- Lined with soft fleece for warmth
- Removable hood and underarm venting, three external pockets and one internal chest pocket

\$129 99



BLACK
S-3XL | 2862569

NAVY
S-3XL | 2862570

WORK VEST

RUGGED AND DURABLE VEST THAT'S IDEAL AS AN OUTDOOR LAYER

- Made of durable nylon fabric to make it the ideal vest for work
- 80g 3M® Thinsulate® Insulation provides great warmth
- Vest comes with plenty of pockets to store your valuables

\$99 99



GRAY
S-3XL | 2860863

BLACK
S-3XL | 2861608

WORK JACKET

WARM AND RUGGED JACKET THAT'S TOUGH FOR WORK AND STYLISH FOR PLAY

- Coated with Durable Water Repellency (DWR) to provide water-resistance
- Built in action back for increased range of motion
- 80g 3M® Thinsulate® for added warmth with brushed flannel trim
- One inner and four outer pockets for storage

\$159 99

REVOLVE VEST

REVERSIBLE

DURABLE AND WARM REVERSIBLE VEST OFFERS TWO STYLES IN ONE

- Durable windbreak outer fabric helps protect from the elements
- 140g 3M® Thinsulate® insulation keeps you warm in cold weather
- Reversible vest offers two unique styles in one

\$99 99



RED
S-3XL | 2833030

BLACK/GRAY
S-3XL | 2862565

WINDBREAKER JACKET

LIGHTWEIGHT, WINDPROOF JACKET THAT PROVIDES PROTECTION WHILE RIDING

- 100% polyester windproof fabric
- Lightweight construction makes it easy to pack
- Three external pockets allow for maximum storage

\$99 99



BLACK
S-3XL | 2861541

FLANNEL JACKET

SHERPA FLEECE LINED JACKET DELIVERS EXCEPTIONAL WARMTH AND COMFORT

- Warm sherpa lined fleece material
- Insulation to keep you warm
- Plenty of storage for your valuables

\$99 99



CHARCOAL
S-3XL | 2860865

BRONZE
S-3XL | 2860864





TITAN MID-LAYER
\$89⁹⁹
■NEW■ Red | S-3XL | 2833026
Black | S-3XL | 2862568
Blue/Orange | S-3XL | 2862567



NORTHSTAR MID-LAYER
\$89⁹⁹
■NEW■ Black/Lime | S-3XL | 2833024
Tan | S-3XL | 2862450



JOURNEY HOODIE
\$69⁹⁹
■NEW■ Navy | S-3XL | 2833066
Black | S-3XL | 2862489



■NEW■
STAPLE HOODIE
\$54⁹⁹
Black | S-3XL | 2833068
Navy | S-3XL | 2833069
Green | S-3XL | 2833070



TECH FULL-ZIP HOODIE
\$64⁹⁹
■NEW■ Red | S-3XL | 2833064
Gray | S-3XL | 2861493



ROGUE HOODIE
\$54⁹⁹
■NEW■ Black | S-3XL | 2833062
■NEW■ Navy | S-3XL | 2833063
Gray | S-3XL | 2862485



STAMP HOODIE
\$54⁹⁹
■NEW■ Green | S-3XL | 2833061
Black | S-3XL | 2862484
Navy | S-3XL | 2861500



CREW SWEATSHIRT
\$49⁹⁹
■NEW■ Gray | S-3XL | 2833067
Black | S-3XL | 2862488
Navy | S-3XL | 2861497



ICON HOODIE
\$54⁹⁹
■NEW■ Black/Red | S-3XL | 2833065
Gray | S-3XL | 2862487
Green | S-3XL | 2861495



ICON LONG SLEEVE
\$29⁹⁹
■NEW■ Lime | S-3XL | 2833083
Gray/Red | S-3XL | 2862505
Black | S-3XL | 2861584



DASH LONG SLEEVE
\$29⁹⁹
■NEW■ Black/Red | S-3XL | 2833082
Navy | S-3XL | 2861583
Black | S-3XL | 2861582



PERFORMANCE LONG SLEEVE
\$39⁹⁹
■NEW■ Gray | S-3XL | 2833168
Black | S-3XL | 2862507



ICON TEE
\$24⁹⁹
■NEW■ Lime | S-3XL | 2833079
Green | S-3XL | 2862501
Black | S-3XL | 2861570



■NEW■
GRAPHIC TEE
\$24⁹⁹
Dark Gray | S-3XL | 2833086
Forest Green | S-3XL | 2833087



FLAG TEE
\$24⁹⁹
Navy | S-3XL | 2862500
White | S-3XL | 2862582

BALL CAPS



NEW
LEATHER PATCH HAT
\$24.99
Black | One Size | 2833129
Gray | One Size | 2833130



NEW
STAPLE CAP
\$24.99
Black | One Size | 2833127
Navy | One Size | 2833128



HIGHLAND CAP
\$24.99
NEW Navy | One Size | 2833126
Tan | One Size | 2860893
Gray | One Size | 2862544



ELLIPSE PATCH TRUCKER HAT
\$24.99
Orange | One Size | 2833124
Light Gray | One Size | 2862539
Gray | One Size | 2861531
Black | One Size | 2861533
Navy | One Size | 2861532



CORE CAP
\$24.99
NEW Red | One Size | 2833123
Gray | One Size | 2862594
Navy | One Size | 2861523
Black | One Size | 2861524



TONAL HAT
\$24.99
Black/Red | One Size | 2861526
Navy | One Size | 2861525



NEW
JOURNEY CAP
\$24.99
Black | One Size | 2833136
Blue | One Size | 2833137



CHECKERED HAT
\$24.99
Blue | One Size | 2861520
Black | One Size | 2861522
Gray | One Size | 2861521



RETRO CAP
\$24.99
NEW Black | One Size | 2833125
Navy | One Size | 2862538
Gray/Red | One Size | 2869542
Gray/Orange | One Size | 2861536

CAMO APPAREL



CAMO SOFTSHELL JACKET
\$129.99
Camo | S-3XL | 2861543



MEN'S CAMO REVOLVE VEST
\$99.99
Camo | S-3XL | 2862572



MEN'S CAMO PURSUIT HOODIE
\$49.99
Camo | S-3XL | 2862494



WOMEN'S CAMO PURSUIT HOODIE
\$49.99
Camo | S-3XL | 2862517



NEW
PURSUIT HOODIE
\$54.99
Black | S-3XL | 2833076
Green | S-3XL | 2833077



CAMO NECK GAITER
\$12.99
Camo | One Size | 2861948



STEALTH CAMO HAT
\$24.99
Camo | One Size | 2861527



HUNTER ORANGE HAT
\$24.99
Orange | S/M | 2860892
Orange | L/XL | 2862545



HUNTER ORANGE BEANIE
\$19.99
Orange | One Size | 2862595



NEW
RADIANT GREEN
S-3XL | 2833039

BLACK
S-3XL | 2862457

NEW
BLACK
S-3XL | 2833041

NEW
RADIANT GREEN
S-3XL | 2833040

BLUE
S-3XL | 2862460

REVOLVE VEST

DURABLE AND WARM REVERSIBLE VEST
OFFERS TWO STYLES IN ONE

- Durable windbreak outer fabric protects you from the elements
- 140g 3M® Thinsulate® insulation keeps you warm in cold weather
- Reversible for two unique styles in one

\$99 99



BLACK
S-3XL | 2861433



BLACK
S-3XL | 2862563

BLUE
S-3XL | 2862564



NEW
RADIANT GREEN
S-3XL | 2833042

BLACK/GRAY
S-3XL | 2862458

FORCE PUFFER JACKET

PACKABLE JACKET OFFERS LIGHTWEIGHT
PROTECTION AND INCREDIBLE WARMTH

- 140g 3M® Thinsulate®
- Two external hand pockets, one internal media pocket
- Rugged YKK® zippers
- Compactable into travel pocket

\$139 99

WORK JACKET

WARM AND RUGGED JACKET THAT'S TOUGH
FOR WORK AND STYLISH FOR PLAY

- 100% nylon shell is coated with DWR to help keep you dry
- 80g 3M® Thinsulate® for added warmth with brushed flannel trim
- Built-in action back for increased range of motion
- One inner and four outer pockets for storage

\$159 99

TITAN MID-LAYER

EXTREMELY WARM YET BREATHABLE
MID-LAYER, PERFECT FOR RIDING

- 319g Polartec® Thermal Pro® Rib Sweater provides great warmth
- Breathable material moves sweat to the outer surface
- Nylon overlay is comfortable and light

\$89 99

SOFTSHELL JACKET

VERSATILE LIGHTWEIGHT JACKET THAT'S
PERFECT FOR EVERYDAY WEAR

- Casual jacket armed with rugged and warm features
- Superior DWR prevents precipitation from saturating the jacket's exterior
- Lined with 280g of soft fleece for warmth
- Removable hood and underarm venting
- Three external pockets and one internal chest pocket

\$129 99

NEW
STAPLE HOODIE
\$54 99
Black | S-3XL | 2833095
Gray | S-3XL | 2833096

JOURNEY HOODIE
\$69 99
NEW Radiant Green | S-3XL | 2833098
Black | S-3XL | 2862515
Blue | S-3XL | 2862516

TECH FULL-ZIP HOODIE
\$64 99
NEW Black | S-3XL | 2833097
Maroon | S-3XL | 2861509
Gray | S-3XL | 2861508



ICON HOODIE
\$54 99
NEW Gray | S-3XL | 2833099
White | S-3XL | 2862512



ADVENTURE CREW
\$49 99
NEW Black/Radiant Green | S-3XL | 2833100
NEW Green | S-3XL | 2833101
Dusty Rose | S-3XL | 2862513
Black | S-3XL | 2862514



NEW
ADVENTURE LONG SLEEVE
\$29 99
Gray | S-3XL | 2833107
Navy | S-3XL | 2833108



NEW
CORE TANK
\$19 99
Black | S-3XL | 2833161
Gray | S-3XL | 2833160



NEW
FLAG TEE
\$24 99
Gray | S-3XL | 2833163
White | S-3XL | 2833162



ADVENTURE TEE
\$24 99
NEW Pink | S-3XL | 2833104
Black Frost | S-3XL | 2862628
Teal | S-3XL | 2862629



RETRO CLOCK
12" | 2868662 | \$29.99



NEW
POLARIS LED SIGN
31.5"x6.5" | 2862736 | \$259.99



ALUMINUM SIGN
22" | 2860867 | \$129.99



WOOD SIGN
24"x10.5" | 2860866 | \$74.99



RETRO GLASSES
(SET OF 2)
2866265 | \$14.99



12oz CAMPER MUG
2861612 | \$29.99



23oz WATER BOTTLE
2862685 | \$24.99



WOODEN COASTERS
2860869 | \$24.99



15oz CAMPFIRE MUG
2861613 | \$19.99



PREMIUM KOOZIE
2860829 | \$7.99



LEATHER LOOP
KEYCHAIN
2861615 | \$14.99



KEYCHAIN
2861614 | \$6.99



KICKBACK ROCKER
2862626 | \$55.00



FREESTYLE ROCKER
2862625 | \$65.00



EASY CHAIR
2862627 | \$45.00



QUICK-E-SEAT
2862624 | \$35.00



FOLDABLE TABLE
2861620 | \$49.99



POP-UP TRASH BIN
2861622 | \$19.99



FLASK
2860812 | \$24.99



DECK OF CARDS
2860816 | \$14.99



HITCH COVER
2861623 | \$34.99



LICENSE
PLATE HOLDER
2862687 | \$19.99



POLARIS
PARKING SIGN
2869934 | \$19.99



POLARIS FLAG
5'x3' | 2869928 | \$24.99



OGIO®

LEARN ABOUT OUR LINE OF OGIO® BAGS ONLINE AT
ATV.POLARIS.COM/OGIOLUGGAGE

Warning: Polaris off-road vehicles can be hazardous to operate and are not intended for on-road use. Driver must be at least 16 years old with a valid driver's license to operate. All riders should always wear helmets, eye protection and protective clothing and footwear. Read, understand and follow your owner's manual. Ride within the limits of your own abilities and never engage in stunt or exhibition driving. Never ride under the influence of drugs or alcohol. All riders should take a safety training course. Call 800-342-3764 for additional information.

Unless noted, trademarks are the property of Polaris Industries Inc. 3M® and Thinsulate® are registered trademarks of 3M Company. 509® is a registered trademark of Teton Outfitters, LLC. App Store® is a registered trademark of Apple Inc. BatteryMINDer® is a registered trademark of VDC Electronics Inc. Bluetooth® is a registered trademark of Bluetooth Sig. Inc. Caliber® is a registered trademark of Caliber, Inc. Facebook™ is a service trademark of Facebook, Inc. Fidlock® is a registered trademark of Fidlock GmbH. FOX® is a registered trademark of Fox Factory Inc. Google Play™ and YouTube® are registered trademarks of GOOGLE LLC. GoPro® is a registered trademark of GoPro Inc. Instagram™ is a service trademark of Instagram, LLC. Kolpin® is a registered trademark of Polaris Industries Inc. MORFLEX® is a registered trademark of FNA Group, Inc. NOCO Genius® is a registered trademark of Noco Company. OGIO® is a registered trademark of Ogio International, Inc. Polartec® is a registered trademark of MMI-IPCO, LLC. RIGID® is a trademark of JST Performance, LLC d/b/a Rigid Industries, LLC. Rockford Fosgate® is a registered trademark of Rockford Corporation. SMART BOARD® is a registered trademark of SMART TECHNOLOGIES ULC UNLIMITED LIABILITY CORPORATION CANADA. TEKVEST® is a registered trademark of 1181676 ONTARIO INC. Tiger Drylac® is a registered trademark of TIGER COATINGS GMBH & CO. KG. Velcro® is a registered trademark of VELCRO BVDA. Twitter™ is a registered trademark of Twitter, Inc. WALKER EVANS RACING® is a registered trademark of Walker Evans Enterprises Incorporated. Yeti® is a registered trademark of Yeti Coolers, LLC. YKK® is a registered trademark of YKK Corporation. Prices, fitment and availability are subject to change at any moment. Copyright © 2022 Polaris Industries Inc. All rights reserved.

FORGE YOUR OWN PATH

GET THE BEST OWNER EXPERIENCE OUT THERE

Our goal is to make every day of ownership a smooth ride. Sign in for access to everything you need, plus exclusive offers and more.

[OFFROAD.POLARIS.COM/ACCOUNT](https://offroad.polaris.com/account)



MY GARAGE

- Vehicle Profile & Accessory Details
- Maintenance Schedules
- Schedule Service
- Manuals & Warranty Info



MY RIDES & COMMUNITY

- My Tracked Rides
- My Planned Routes & POIs
- My Community Activities & Events
- Explore Polaris Adventures



MY SHOPPING

- Recommended Accessories
- Purchase History
- My Dealer
- Access to Polaris Pros



CONNECT ONLINE
SEARCH "PolarisORV"



BUILD YOUR POLARIS SPORTSMAN

1 CHOOSE
MODEL

2 CHOOSE
TRIM

3 CHOOSE
COLOR

4 CHOOSE
ACCESSORIES



VISIT [POLARIS.COM/SPORTSMAN](https://polaris.com/sportsman)
TO SEE VEHICLE OPTIONS AND VIEW ACCESSORIES
ON YOUR NEW MACHINE FROM EVERY ANGLE!

POLARIS
Think Outside